



CHAIFU ROBOT

China's leading intelligent manufacturing company
in industrial robotics and full industrial chain development



Contact Us

☎ 400 822 7688

✉ contact@chaifurobot.com

📍 No.288, Zhenkai Road, Zhangyan Town, Jinshan District, Shanghai

🌐 www.chaifurobot.com/en



Shanghai Chaifu Robot Co., Ltd.

CONTENTS

Introduction

Internal Zone

Load Test Block	04
Low-Payload Robot and Stamping Press Robot	05
High-Payload Robot and Heavy-Duty Robot	05
Desktop Robots and Welding Robots	06
LIKE Heat Treatment Department	08

Core Technologies

Robotics R&D Department	16
Robotics Manufacturing Department	17

Products

SF PRENTIC Series | Desktop Robots

SF7-K759	26
SF8-K950	28

SF ARC Series | Welding Robots

SF6-C1400X	30
SF6-C2080X	32

SF LOTIC Series | Low-Payload Robot

SF6-C1200	34
SF10-C1650	36
SF10-K2032	38
SF10-K3100	40

SF MIMETIC Series | Medium-Duty robot

SF20-K1735	42
SF20-C2150	44
SF30-C1850	46
SF50-K2178	48
SF50-C2185	50
SF80-C2600	52
SF120-C2269	54

SF BIOTIC Series | High-Payload Robot

SF210-K2650	56
-------------	----

SF ALPHTIC Series | Heavy-Duty Robot

SF500-C3100	58
-------------	----

SF PRESS Series | Stamping Press Robot

SF8-K1400	60
SF15-C1538	62
SF25-C1760	64
SF25-C1900	66

SF PA Series | Palletizing Robot

SF50-K2220	68
SF130-K2700	70
SF180-C3200	72
SF210-K3200	74

SF ALPHTIC Series | Heavy-Duty Robot

SF500-C3200	76
SF800-C3200	78
SF1600-C4000	80



35,000²



Annual Output of Industrial Robots	Annual Output of Precision Joint Reducers	Service Centers Covers the Entire Country
5k Units	80k Units	70%

About CHAIFU

Shanghai Chaifu Robotics Co., Ltd. is an industrial automation company for development and intelligent manufacturing and an intelligent manufacturing company in China with the development and production capacity of the entire industrial robot and automation industry chain.

The Shanghai Super Factory provides nearly 35,000 square meters of space for intelligent manufacturing equipment with the highest precision manufacturing and inspection equipment globally for the development and manufacturing, commissioning installation, and factory inspection of industrial gearboxes, systems, and controllers.

As one of the leading suppliers of intelligent manufacturing solutions for automation in China, CHAIFU has a wide range of solutions in the industrial sector: from individual robotic work cells to complete automation systems for a wide range of applications in electronics, metal products, machinery manufacturing, logistics, and transport as well as in craft art.

01

CHAIFU

Internal Zone





Load Test Block |



Low-Payload Robot and Stamping Press Robot

02

03

Desktop Robots and Welding Robots

**DESK TOP
SERIES
AND WELDING
SERIES
TEST AREA**



The core precision gearbox components will all be heat treated and processed into the precision workshop

INDUSTRIAL HEAT TREATMENT TECHNOLOGY DEPARTMENT



04

LIKE Heat Treatment Department





The highest precision manufacturing and testing facilities in the world for industrial gearboxes, development and manufacture of systems and controllers, commissioning installation and factory inspection.

DUST-FREE CONSTANT TEMPERATURE WORKSHOP



TECHNOLOGIES



CHAIFU INTELLIGENCE | Software Development Dept.



CHAIFU DYNAMICS | Servo Motor Manufacturing Dept.



CHAIFU ELECTRIC | Servo Drive Manufacturing Dept.



LIKE PRECISION | RV Gearbox Manufacturing Dept.

Robotics R&D Department



CHAIFU INTELLIGENCE | Software Development Dept.

Controller Series: **COREFORCE**®

R&D | Development of the robot's internal control system from the underlying source code, Customized software packages to meet different process requirements



Robotics Manufacturing Department



LIKE PRECISION | RV Gearbox Manufacturing Dept.

RV Gearbox product series: **LIKE PRECISION**®

Breaking the monopoly, Self-developed ultra-high precision RV reducer successfully introduced to the market RV reducer department's product performance has reached the international advanced level, Capacity potential of 100,000 units of precision joint reducers, Now has 12 series of 522 specifications, Nearly 10,000 speed ratios of transmission products, After years of market validation the average failure rate is less than 0.5%



The product performance of RV reducer department has reached or even exceeded some imported products, Capacity potential of 100,000 units of precision joint reducers, Now has 12 series of 522 specifications, Nearly 10,000 speed ratios of transmission products, After years of market verification failure rate of less than 0.1%





CHAIFU DYNAMICS | Software Development Dept.

Servo motor product series: **SERVOFORCE**®

Through the accumulation of abundant cases over time, Tens of thousands of R&D experiments, The Servo Motor Technology team provides Chafer with reliable and robust servo motor technology and products with minimal maintenance requirements, Continuously reduce your cost of ownership



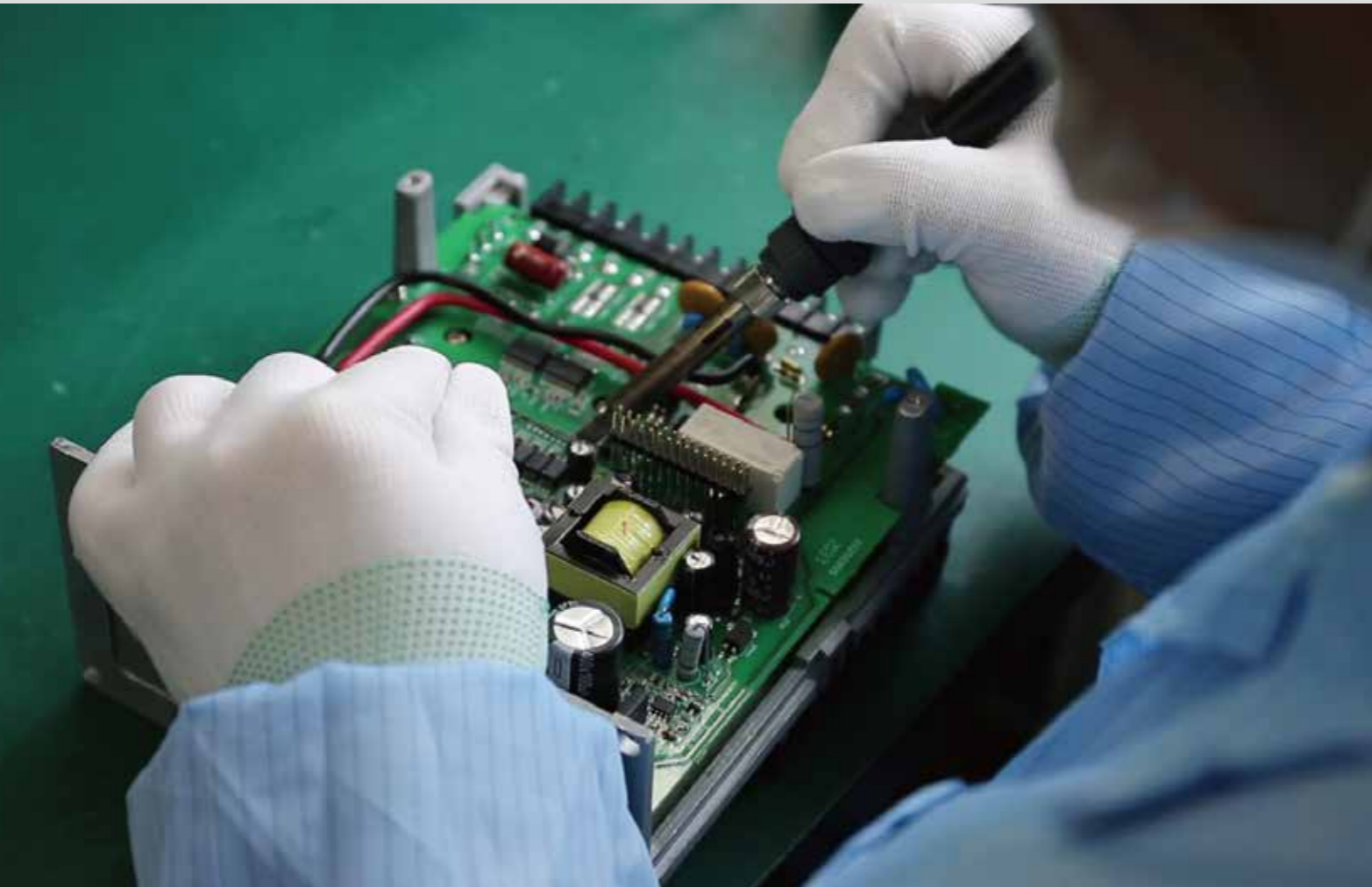

CHAIFU ELECTRIC | Servo Drive Manufacturing Dept.

Servo Drive Product Series: **COREDRIIVE**®

Industry advanced servo drive technology

The industry's advanced servo drive technology is attributed to the multi-axis integrated servo drive, Built-in dynamic braking and vibration suppression is possible, Built-in software through various independently developed servo drives, You can find the industry needs more precisely.

PRODUCT

CENTER

SF ARC Series
Welding Robots

SF LOTIC Series
Low-Payload Robot

SF MIMETIC Series
Medium-Duty Robot

SF BIOTIC Series
High-Payload Robot

SF ALPHTIC Series
Heavy-Duty Robot

SF PRENTIC Series
Desktop Robot

SF PA Series
Palletizing Robot

SF PRESS Series
Stamping Press Robot

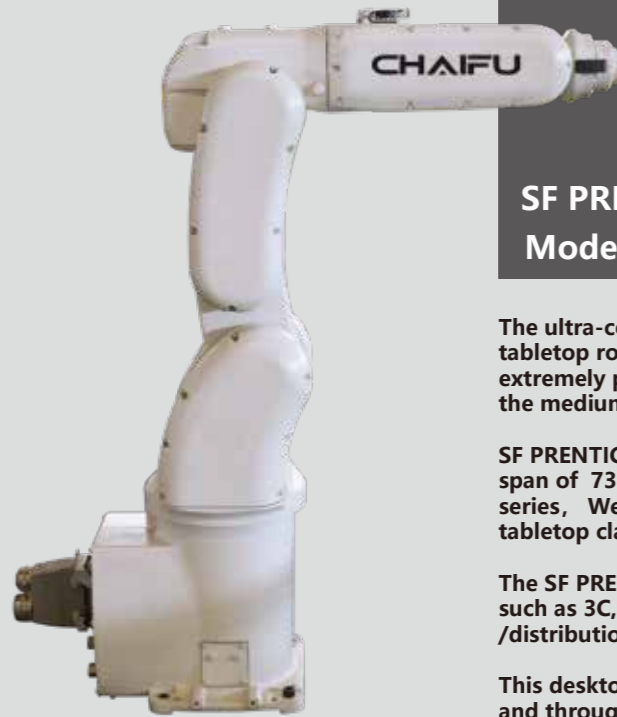

SF PRENTIC Series | Desktop robots Model: SF7-k759

The ultra-compact SF PRENTIC series are compact and flexible tabletop robots that are powerful, fast, and efficient, enabling extremely precise and agile robots for various applications in the medium load class, no matter how small the parts are.

SF PRENTIC has a maximum load capacity of 7 kg and an arm span of 737.5 mm. With the introduction of the SF PRENTIC series, We are redefining the benchmark for robots in the tabletop class below 7 kg.

The SF PRENTIC series is ideal for applications in tight spaces such as 3C, handling, painting, welding, pick/pack, and assembly /distribution.

This desktop-class robot is tailored for the pursuit of performance and throughput.

Applications



SF7-K759 Data Overview

Model	SF7-K759	
Structure	Vertically Articulated	
Number of Axis	6	
Radius	737.5mm	
Payload	7kg	
Repeatability	±0.04mm	
Drive Mode	AC Servo Motor	
Maximum Speed	J1	305° /s
	J2	280° /s
	J3	300° /s
	J4	300° /s
	J5	406° /s
	J6	600° /s
Range of Motion	J1	±171°
	J2	+65° / -141°
	J3	+170° / -66°
	J4	±180°
	J5	±119°
	J6	±360°
Allowable Moment	J4	15.6N.M
	J5	15.6N.M
	J6	8.5N.M
Allowable Inertia	J4	0.43kg.m2
	J5	0.43kg.m2
	J6	0.13kg.m2
Protection Rating	IP65	
Operating Conditions	Temp.	0-45°C
	Humidity	Below 95%RH
	Vibration	Below 4.9m/s2
	Other	Eliminate Signal Noise
Base Size	210*235mm	
Height	880mm	
Weight	48KG	
Mounting Positions	Floor	
Weight	1.5kVA	

SF7-K759 Range of Motion

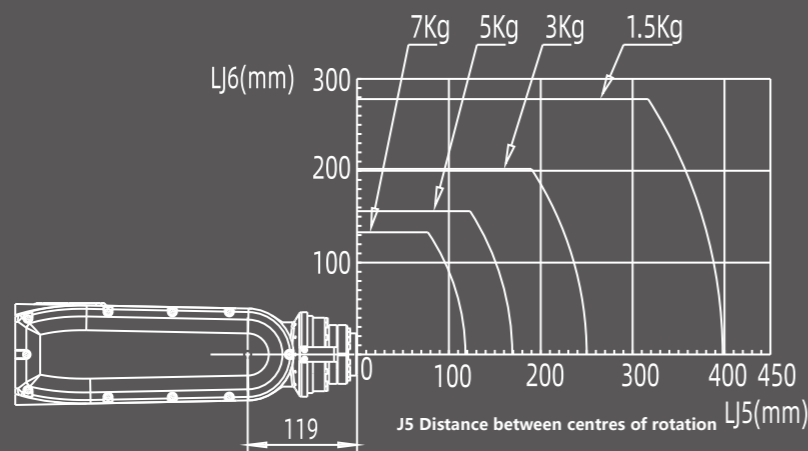
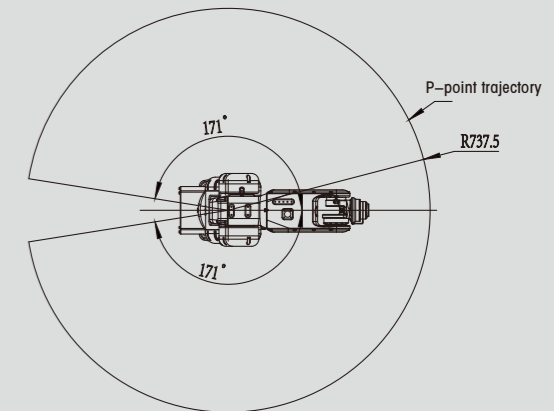
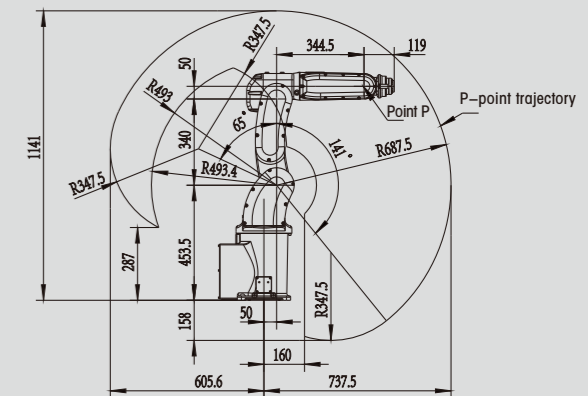

SF7-K759 Wrist load torque chart

Note: The centre of gravity point of the load should be within the wrist torque diagram when in use

External & Installation Dimensions

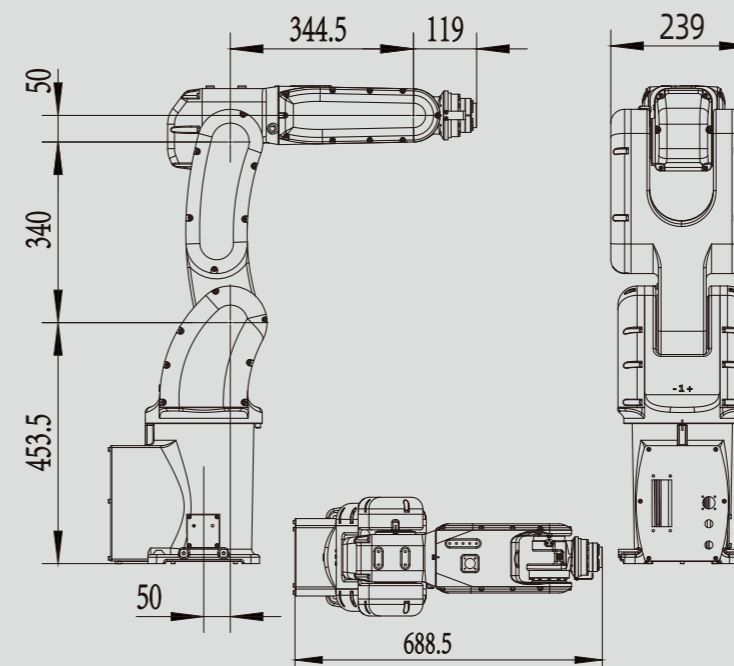

A-Way Diagram (End Flange Mounting Dimensions)

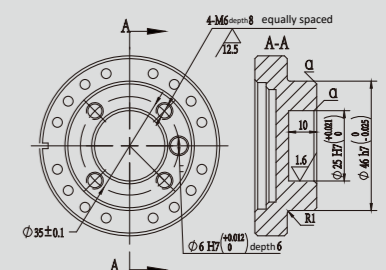

B-Way Diagram (Base Mounting Dimensions)

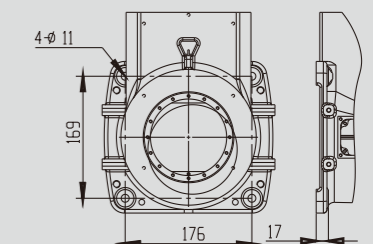



SF ARC Series | Welding robots Model: SF6 - C1400X

The SF ARC is your most vital partner in the field of industrial arc welding, with the innovative technology of the Hollow Wrist, which ensures extremely short motion cycles and the highest precision trajectory.

The SF ARC is capable of working at extremely high trajectory accuracy and speed, with convincingly higher accuracy and better performance, easy maintenance features to minimize follow-up costs.

The SF ARC has the better performance and higher power density for arc welding, cutting, handling, machine loading and unloading, picking /packing, and assembly/disassembly.

The equipment performs efficiently and stably at long and short distances through acceleration and deceleration switching technology. Higher efficiency and economic benefits are achieved with a maximum speed of over 700 °/s due to fine grading and higher core computing.

Applications

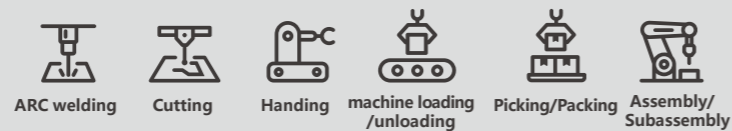

SF6-C1400X Data Overview

Model	SF6-C1400X	
Structure	Vertically Articulated	
Number of Axis	6	
Radius	1443.5mm	
Payload	6kg	
Repeatability	±0.05mm	
Drive Mode	AC Servo Motor	
Maximum Speed	J1	240° /s
	J2	240° /s
	J3	260° /s
	J4	400° /s
	J5	400° /s
	J6	700° /s
Range of Motion	J1	±170°
	J2	+90° /-155°
	J3	+155° /-86°
	J4	±155°
	J5	+134° /-132°
	J6	±220°
Allowable Moment	J4	10N.M
	J5	10N.M
	J6	5.5N.M
Allowable Inertia	J4	0.28kg.m2
	J5	0.28kg.m2
	J6	0.06kg.m2
Protection Rating	IP 65	
Operating Conditions	Temp.	0-45°C
	Humidity	Below 95%RH
	Vibration	Below 4.9m/s2
	Other	Eliminate Signal Noise
Base Size	355*355mm	
Height	1375mm	
Weight	150KG	
Mounting Positions	Floor, Wall, Ceiling	
Weight	3kVA	

SF6-C1400X Range of Motion

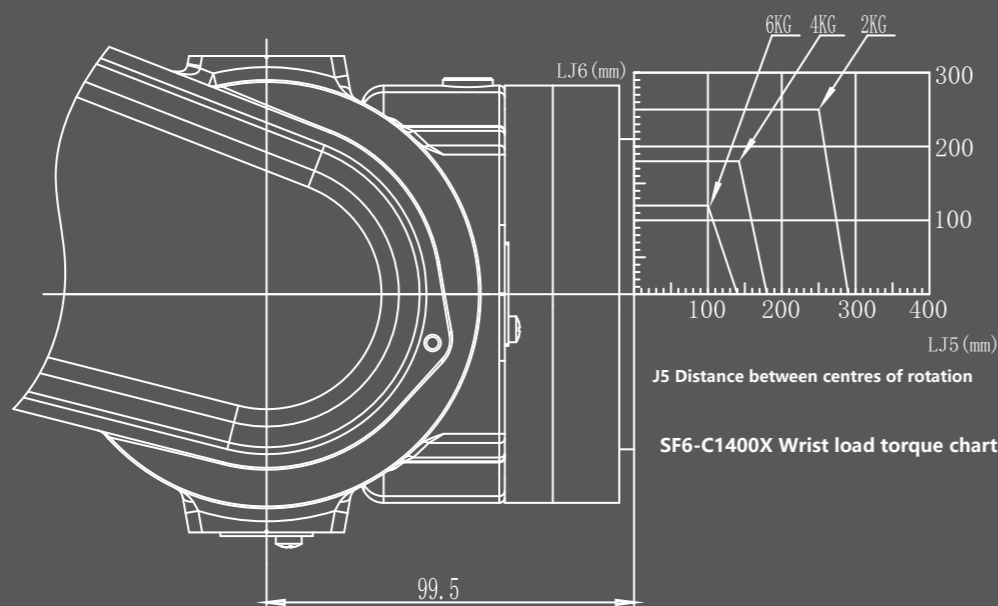
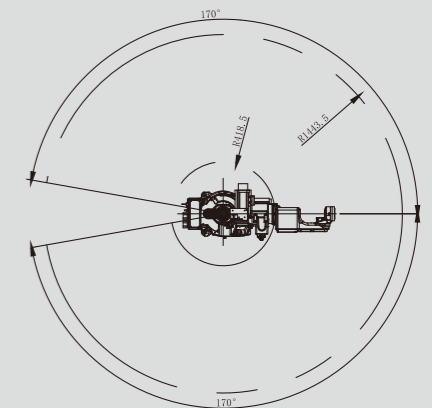
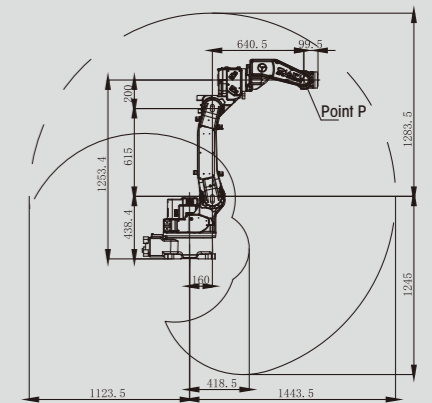

External & Installation Dimensions

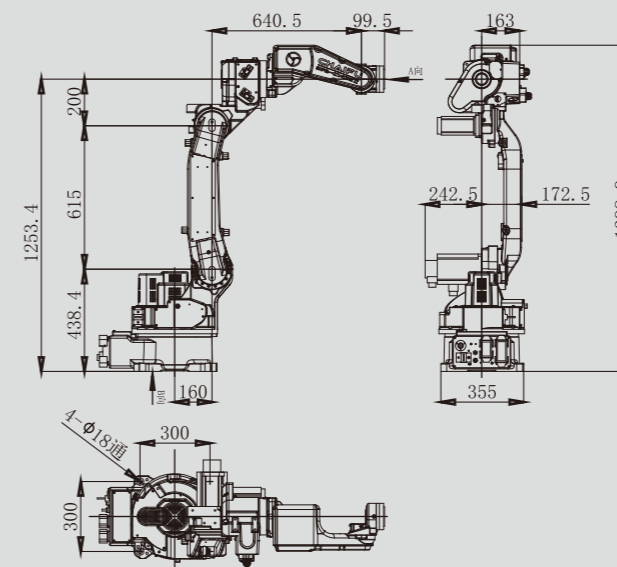

A-Way Diagram (End Flange Mounting Dimensions)

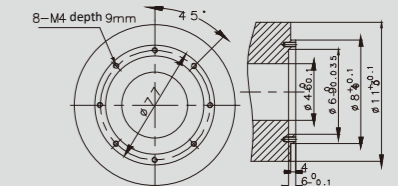

B-Way Diagram (Base Mounting Dimensions)

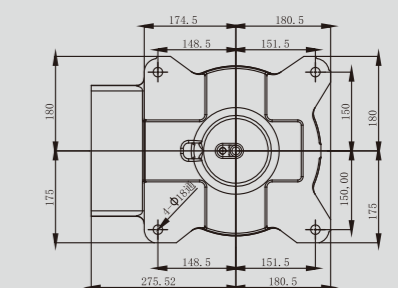



SF LOTIC Series | Low-Payload Robot
Model: SF10 - C1650

The SF LOTIC is a series of low payload industrial robots tailored to handle small objects with excellent performance and flexibility at all times.

SF LOTIC is your indispensable helper in making cost-effective choices with a wide range of products.

With a finely segmented maximum movement radius of 1651 mm, you can precisely define the robot you need with excellent performance and stability while paying less for investment and energy costs.

All SF LOTIC series are equipped with LIKEPRECISION technology, the ultra-precise RV Precision Gearbox, which allows the robot to take full advantage even at high operating speeds.

Applications

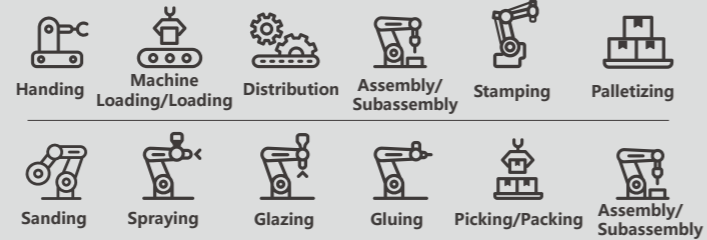

SF10-C1650 Data Overview

Model	SF10-C1650	
Structure	Vertically Articulated	
Number of Axis	6	
Radius	1651 mm	
Payload	10kg	
Repeatability	±0.05mm	
Drive Mode	AC Servo Motor	
Maximum Speed	J1	150° /s
	J2	148° /s
	J3	160° /s
	J4	300° /s
	J5	300° /s
	J6	500° /s
Range of Motion	J1	±165°
	J2	+75° /-125°
	J3	+145° /-75°
	J4	±178°
	J5	±125°
	J6	±720°
Allowable Moment	J4	22N.M
	J5	22N.M
	J6	10N.M
Allowable Inertia	J4	1kg.m2
	J5	1kg.m2
	J6	0.2kg.m2
Protection Rating	IP 65	
Operating Conditions	Temp.	0-45°C
	Humidity	Below 95%RH
	Vibration	Below 4.9m/s2
	Other	Eliminate Signal Noise
Base Size	384*384mm	
Height	1407mm	
Weight	196KG	
Mounting Positions	Any angle	
Weight	2.5kVA	

SF10-C1650 Range of Motion

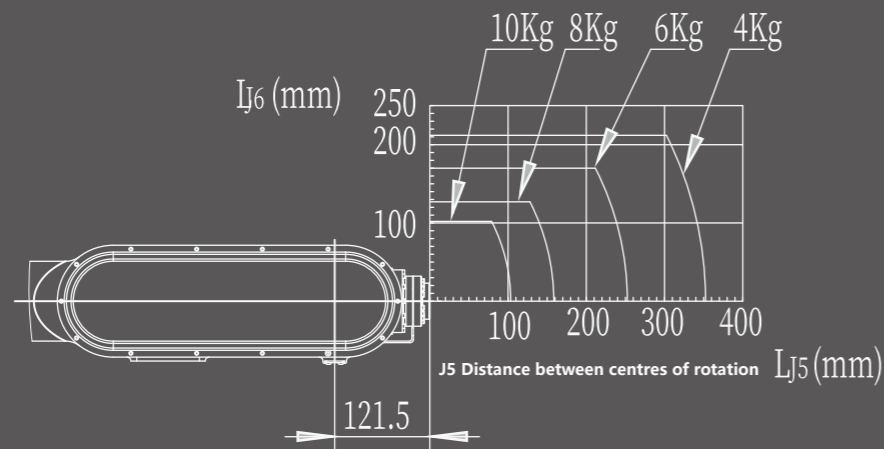
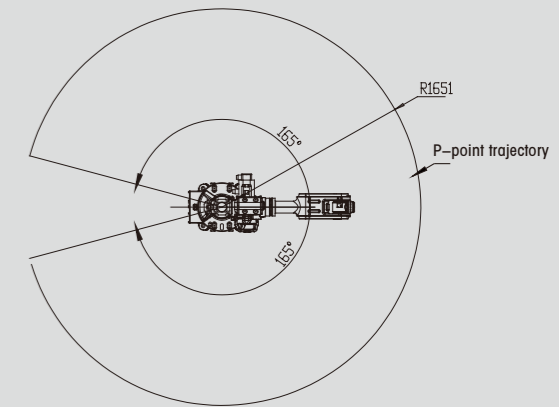
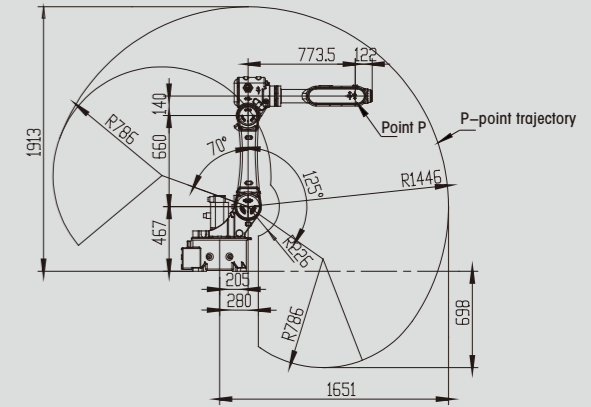

SF10-C1650 Wrist load torque chart

Note: The centre of gravity point of the load should be within the wrist torque diagram when in use

External & Installation Dimensions

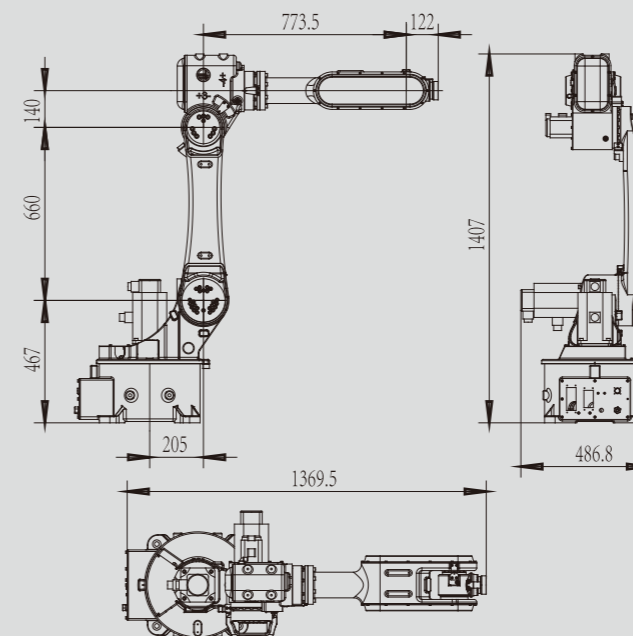

A-Way Diagram (End Flange Mounting Dimensions)

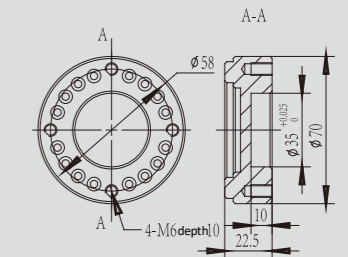

B-Way Diagram (Base Mounting Dimensions)

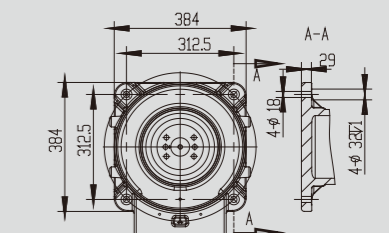

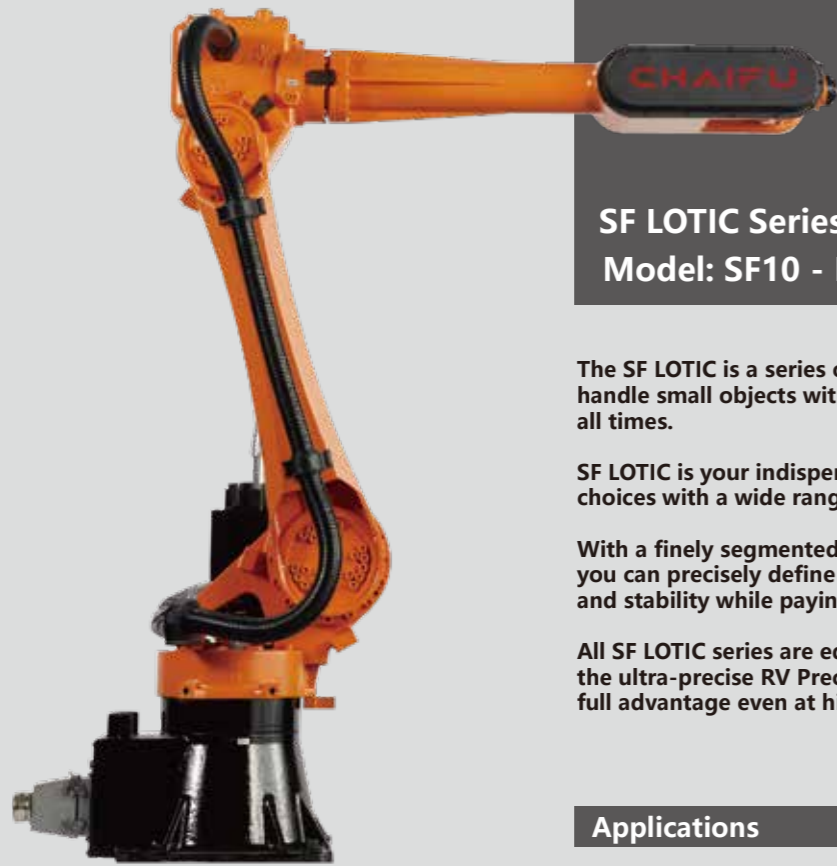

SF LOTIC Series | Low-Payload Robot
Model: SF10 - K2032

The SF LOTIC is a series of low payload industrial robots tailored to handle small objects with excellent performance and flexibility at all times.

SF LOTIC is your indispensable helper in making cost-effective choices with a wide range of products.

With a finely segmented maximum movement radius of 2030 mm, you can precisely define the robot you need with excellent performance and stability while paying less for investment and energy costs.

All SF LOTIC series are equipped with LIKEPRECISION technology, the ultra-precise RV Precision Gearbox, which allows the robot to take full advantage even at high operating speeds.

Applications



SF10-K2032 Data Overview

Model	SF10-K2032	
Structure	Vertically Articulated	
Number of Axis	6	
Radius	2030mm	
Payload	10kg	
Repeatability	±0.05mm	
Drive Mode	AC Servo Motor	
Maximum Speed	J1	141.6° /s
	J2	135° /s
	J3	141.6° /s
	J4	300° /s
	J5	300° /s
	J6	500° /s
Range of Motion	J1	±175°
	J2	+68° /-150°
	J3	+150° /-75°
	J4	±178°
	J5	±135°/-125°
	J6	±720°
Allowable Moment	J4	22N.M
	J5	22N.M
	J6	10N.M
Allowable Inertia	J4	1kg.m2
	J5	1kg.m2
	J6	0.2kg.m2
Protection Rating	IP 65	
Operating Conditions	Temp.	0-45°C
	Humidity	Below 95%RH
	Vibration	Below 4.9m/s2
	Other	Eliminate Signal Noise
Base Size	370*370mm	
Height	1563mm	
Weight	208KG	
Mounting Positions	Any angle	
Weight	3.25kVA	

SF10-K2032 Range of Motion

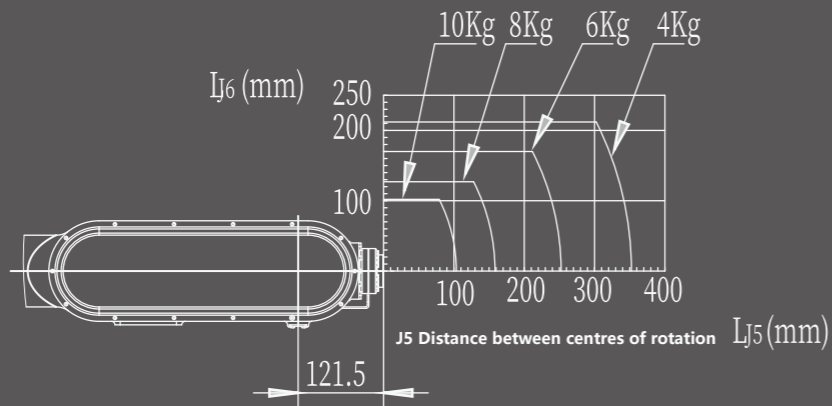
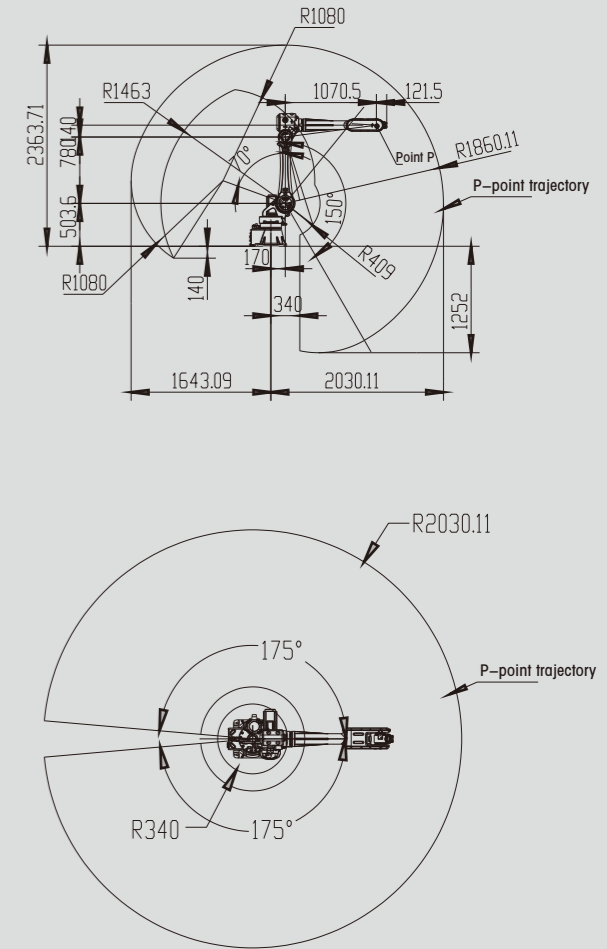

SF10-K2032 Wrist load torque chart

Note: The centre of gravity point of the load should be within the wrist torque diagram when in use

External & Installation Dimensions

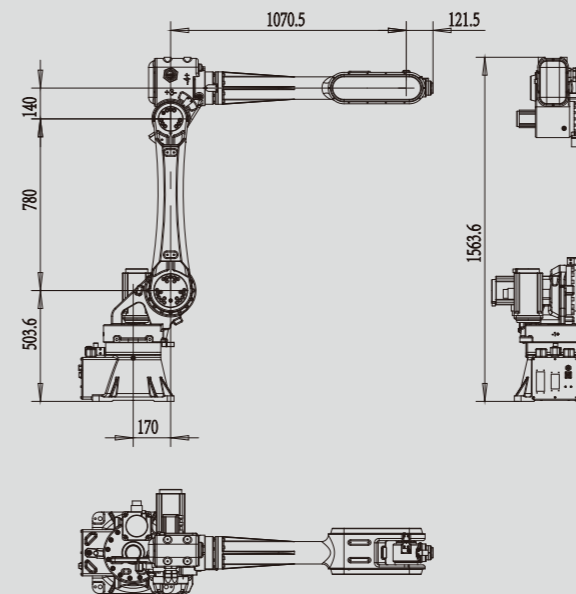

A-Way Diagram (End Flange Mounting Dimensions)

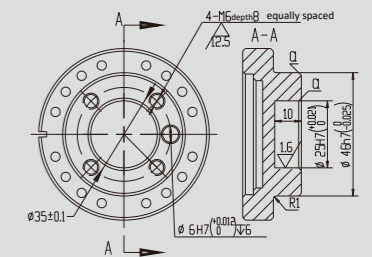

B-Way Diagram (Base Mounting Dimensions)

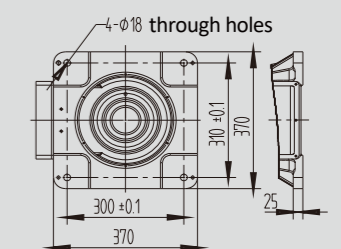



SF LOTIC Series | Low-Payload Robot
Model: SF10 - K3100

The SF LOTIC is a series of low payload industrial robots tailored to handle small objects with excellent performance and flexibility at all times.

SF LOTIC is your indispensable helper in making cost-effective choices with a wide range of products.

With a finely segmented maximum movement radius of 3100 mm, you can precisely define the robot you need with excellent performance and stability while paying less for investment and energy costs.

All SF LOTIC series are equipped with LIKEPRECISION technology, the ultra-precise RV Precision Gearbox, which allows the robot to take full advantage even at high operating speeds.

Applications



SF10-K3100 Data Overview

Model	SF10-K3100	
Structure	Vertically Articulated	
Number of Axis	6	
Radius	3100mm	
Payload	10kg	
Repeatability	±0.08mm	
Drive Mode	AC Servo Motor	
Maximum Speed	J1	125° /s
	J2	125° /s
	J3	140° /s
	J4	200° /s
	J5	210° /s
	J6	290° /s
Range of Motion	J1	±172°
	J2	+72° /-140°
	J3	+150° /-80°
	J4	±360°
	J5	±125°
	J6	±360°
Allowable Moment	J4	22N.M
	J5	22N.M
	J6	10N.M
Allowable Inertia	J4	1kg.m2
	J5	1kg.m2
	J6	0.2kg.m2
Protection Rating	IP 65	
Operating Conditions	Temp.	0-45°C
	Humidity	Below 95%RH
	Vibration	Below 4.9m/s2
	Other	Eliminate Signal Noise
Base Size	573*629mm	
Height	1899mm	
Weight	596KG	
Mounting Positions	Any angle	
Weight	4.5kVA	

SF10-K3100 Range of Motion

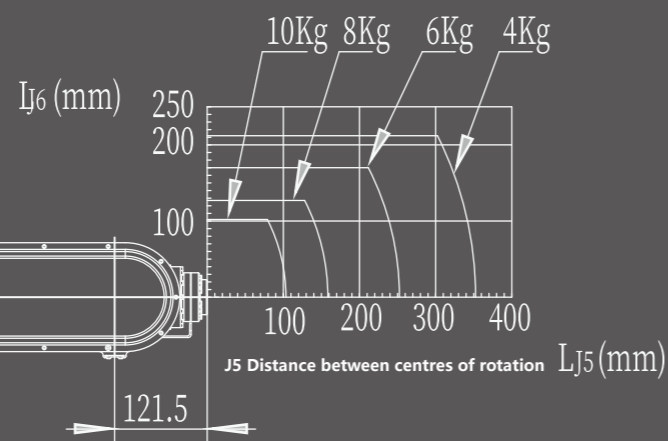
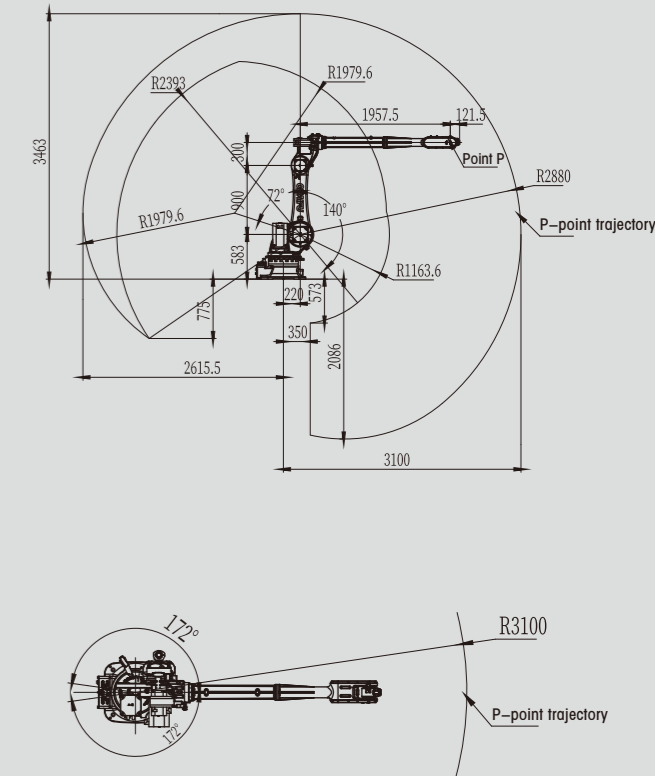

SF10-K3100 Wrist load torque chart

Note: The centre of gravity point of the load should be within the wrist torque diagram when in use

External & Installation Dimensions

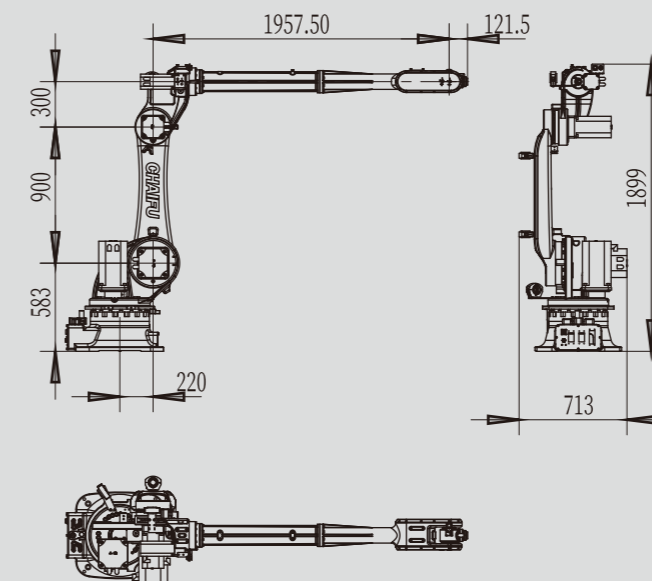

A-Way Diagram (End Flange Mounting Dimensions)

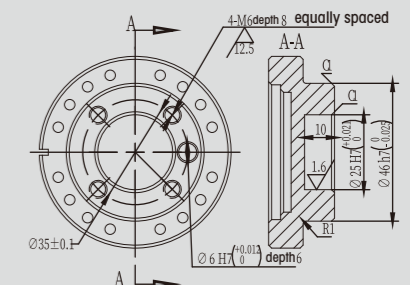

B-Way Diagram (Base Mounting Dimensions)

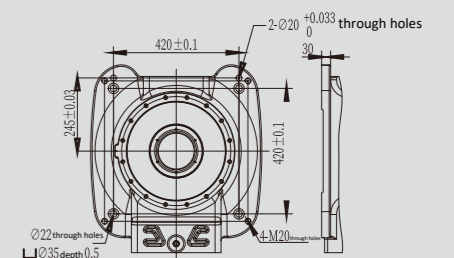



SF MIMETIC Series | Medium duty robot
Model: SF20 - K1735

The SF MIMETIC is a medium payload industrial robot with a superior working range, advanced servo control technology, and an extremely rigid arm, significantly reducing cycle times and ensuring high productivity.

SF MIMETIC is a complete solution for medium payload class industrial robots to secure your future planning and production investment. From 20 kg up to 120 kg of fine load breakdown.

It is the perfect solution to ensure accuracy and production quality. Whether handling, machine loading/unloading, painting, stamping, palletizing, grinding, picking/packing, or assembly/distribution. In addition, you will have the freedom to choose the robot corresponding to your actual needs for greater efficiency and economic benefits.

All SF MIMETIC series are equipped with LIKEPRECISION technology, the ultra-precise RV Precision Gearbox, which enables the robot to take full advantage of its advantages even at high operating speeds.

Applications

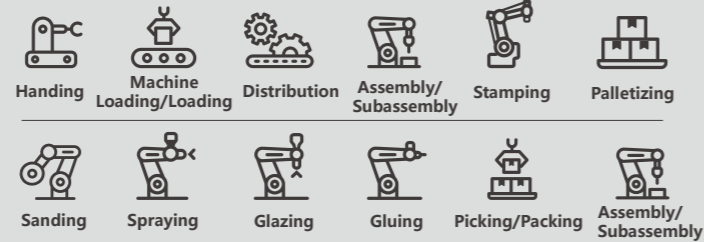

SF20-K1735 Data Overview

Model	SF20-K1735	
Structure	Vertically Articulated	
Number of Axis	6	
Radius	1735mm	
Payload	20kg	
Repeatability	±0.05mm	
Drive Mode	AC Servo Motor	
Maximum Speed	J1	141.6° /s
	J2	135° /s
	J3	141.6° /s
	J4	300° /s
	J5	300° /s
	J6	500° /s
Range of Motion	J1	±175°
	J2	+68° /-150°
	J3	+150° /-75°
	J4	±178°
	J5	±125° /-125°
	J6	±720°
Allowable Moment	J4	42N.M
	J5	42N.M
	J6	23N.M
Allowable Inertia	J4	1.26kg.m2
	J5	1.26kg.m2
	J6	0.49kg.m2
Protection Rating	IP 65	
Operating Conditions	Temp.	0-45°C
	Humidity	Below 95%RH
	Vibration	Below 4.9m/s2
	Other	Eliminate Signal Noise
Base Size	370*370mm	
Height	1563mm	
Weight	206KG	
Mounting Positions	Any angle	
Weight	3.25kVA	

SF20-K1735 Range of Motion

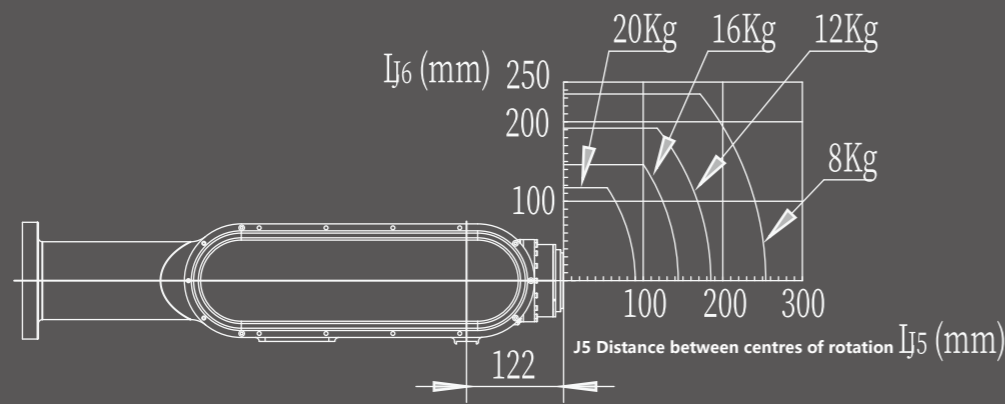
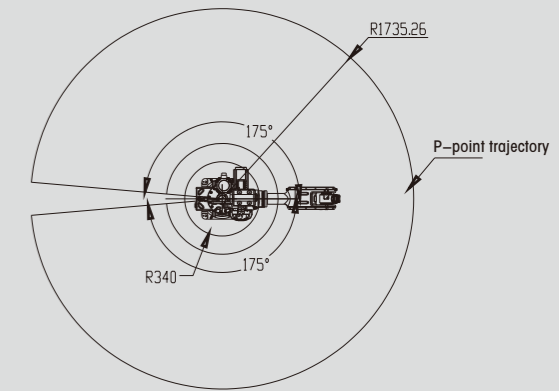
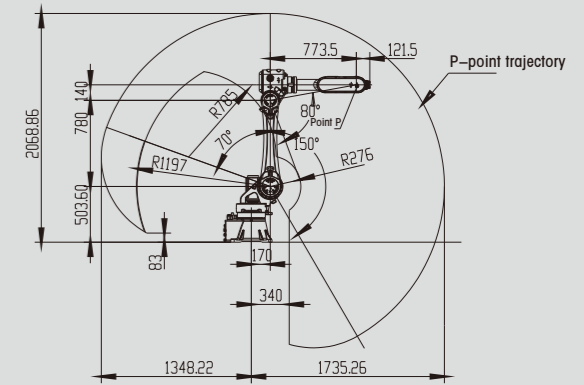

SF20-K1735 Wrist load torque chart

Note: The centre of gravity point of the load should be within the wrist torque diagram when in use

External & Installation Dimensions

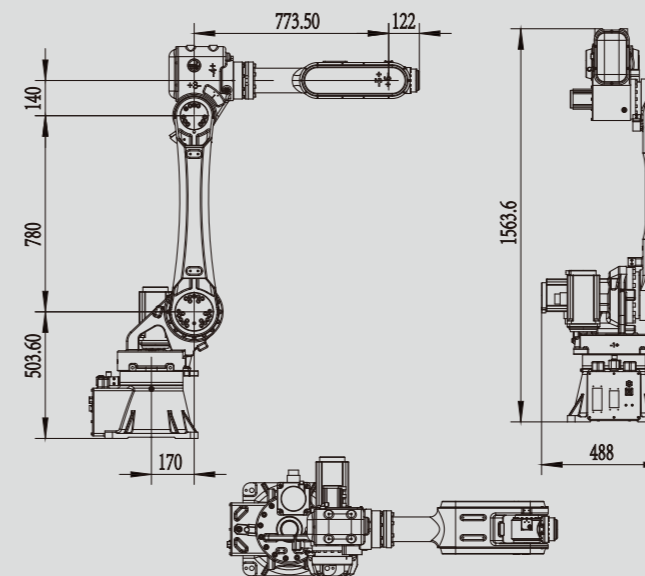

A-Way Diagram (End Flange Mounting Dimensions)

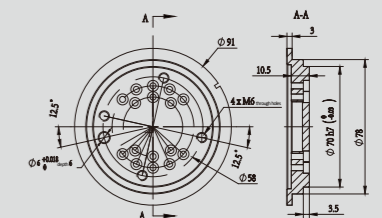

B-Way Diagram (Base Mounting Dimensions)

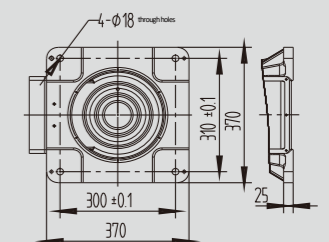



SF MIMETIC Series | Medium duty robot
Model: SF20 - C2150

The SF MIMETIC is a medium payload industrial robot with a superior working range, advanced servo control technology, and an extremely rigid arm, significantly reducing cycle times and ensuring high productivity.

SF MIMETIC is a complete solution for medium payload class industrial robots to secure your future planning and production investment. From 20 kg up to 120 kg of fine load breakdown.

It is the perfect solution to ensure accuracy and production quality. Whether handling, machine loading/unloading, painting, stamping, palletizing, grinding, picking/packing, or assembly/distribution. In addition, you will have the freedom to choose the robot corresponding to your actual needs for greater efficiency and economic benefits.

All SF MIMETIC series are equipped with LIKEPRECISION technology, the ultra-precise RV Precision Gearbox, which enables the robot to take full advantage of its advantages even at high operating speeds.

Applications

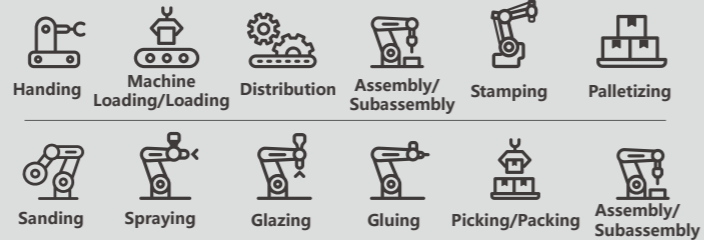

SF20-C2150 Data Overview

Model	SF20-C2150	
Structure	Vertically Articulated	
Number of Axis	6	
Radius	2150mm	
Payload	20kg	
Repeatability	±0.06mm	
Drive Mode	AC Servo Motor	
Maximum Speed	J1	140° /s
	J2	140° /s
	J3	140° /s
	J4	350° /s
	J5	230° /s
	J6	250° /s
Range of Motion	J1	±170°
	J2	+100° /-157°
	J3	+95° /-80°
	J4	±180°
	J5	±125°/-125°
	J6	±720°
Allowable Moment	J4	42N.M
	J5	42N.M
	J6	23N.M
Allowable Inertia	J4	1.26kg.m2
	J5	1.26kg.m2
	J6	0.49kg.m2
Protection Rating	IP 65	
Operating Conditions	Temp.	0-45°C
	Humidity	Below 95%RH
	Vibration	Below 4.9m/s2
	Other	Eliminate Signal Noise
Base Size	396*396mm	
Height	1618.5mm	
Weight	246KG	
Mounting Positions	Any angle	
Weight	3.8kVA	

SF20-C2150 Range of Motion

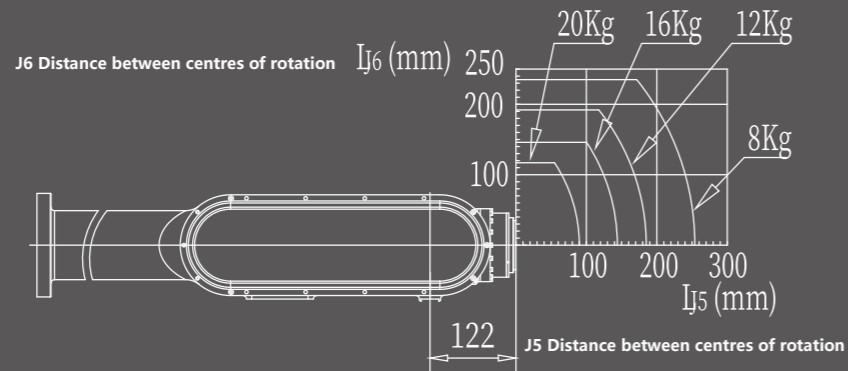
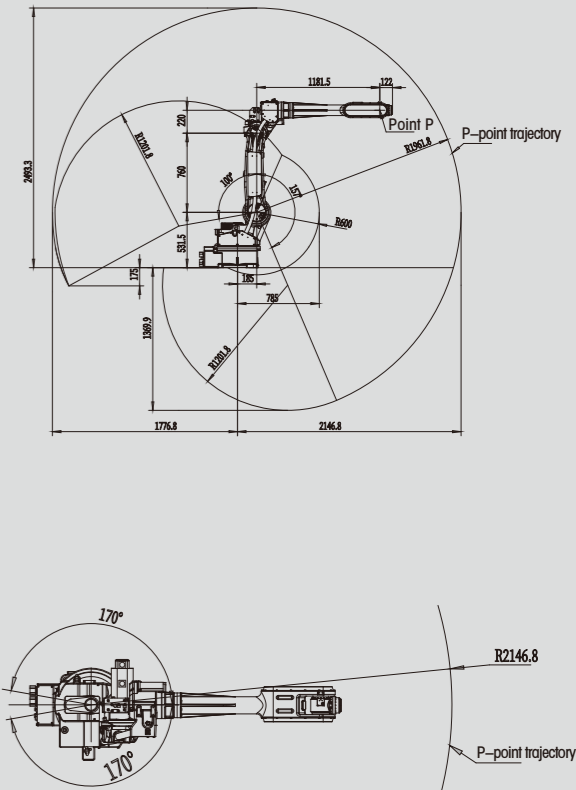

SF20-C2150 Wrist load torque chart

Note: The centre of gravity point of the load should be within the wrist torque diagram when in use

External & Installation Dimensions

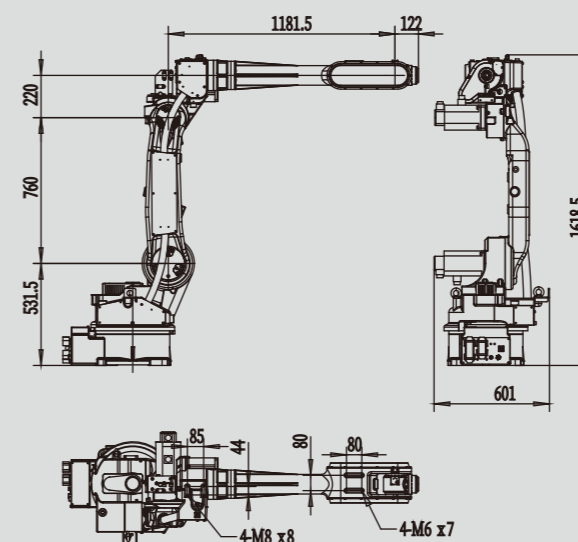

A-Way Diagram (End Flange Mounting Dimensions)

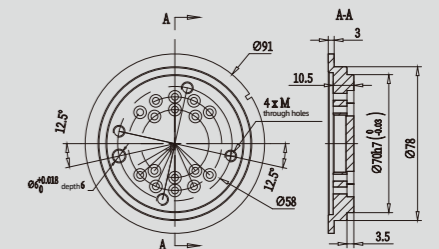

B-Way Diagram (Base Mounting Dimensions)

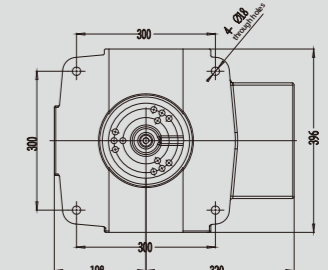



SF MIMETIC Series | Medium duty robot
Model: SF30 - C1850

The SF MIMETIC is a medium payload industrial robot with a superior working range, advanced servo control technology, and an extremely rigid arm, significantly reducing cycle times and ensuring high productivity.

SF MIMETIC is a complete solution for medium payload class industrial robots to secure your future planning and production investment. From 20 kg up to 120 kg of fine load breakdown.

It is the perfect solution to ensure accuracy and production quality. Whether handling, machine loading/unloading, painting, stamping, palletizing, grinding, picking/packing, or assembly/distribution. In addition, you will have the freedom to choose the robot corresponding to your actual needs for greater efficiency and economic benefits.

All SF MIMETIC series are equipped with LIKEPRECISION technology, the ultra-precise RV Precision Gearbox, which enables the robot to take full advantage of its advantages even at high operating speeds.

Applications

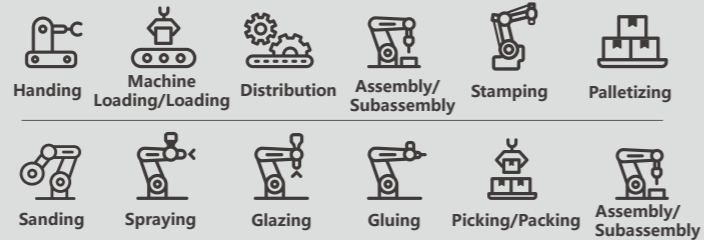

SF30-C1850 Data Overview

Model	SF30-C1850	
Structure	Vertically Articulated	
Number of Axis	6	
Radius	1856mm	
Payload	30kg	
Repeatability	±0.06mm	
Drive Mode	AC Servo Motor	
Maximum Speed	J1	170° /s
	J2	170° /s
	J3	170° /s
	J4	350° /s
	J5	230° /s
	J6	230° /s
Range of Motion	J1	±175°
	J2	+68° /-150°
	J3	+150° /-75°
	J4	±178°
	J5	+125° /-125°
	J6	±720°
Allowable Moment	J4	42N.M
	J5	42N.M
	J6	23N.M
Allowable Inertia	J4	1.26kg.m2
	J5	1.26kg.m2
	J6	0.49kg.m2
Protection Rating	IP 65	
Operating Conditions	Temp.	0-45°C
	Humidity	Below 95%RH
	Vibration	Below 4.9m/s2
	Other	Eliminate Signal Noise
Base Size	396*396mm	
Height	1602.5mm	
Weight	228KG	
Mounting Positions	Any angle	
Weight	3.8kVA	

SF30-C1850 Range of Motion

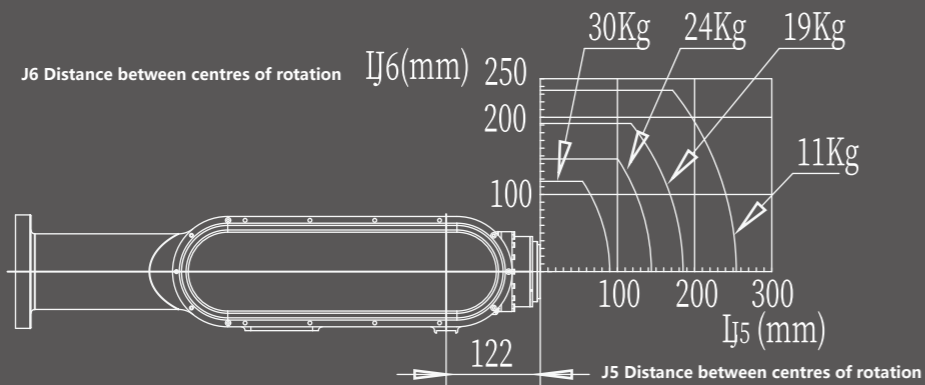
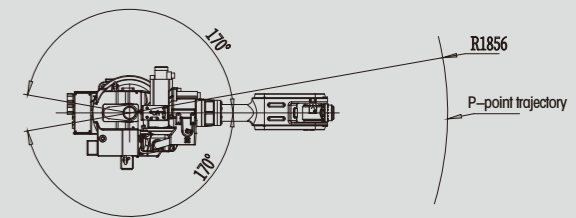
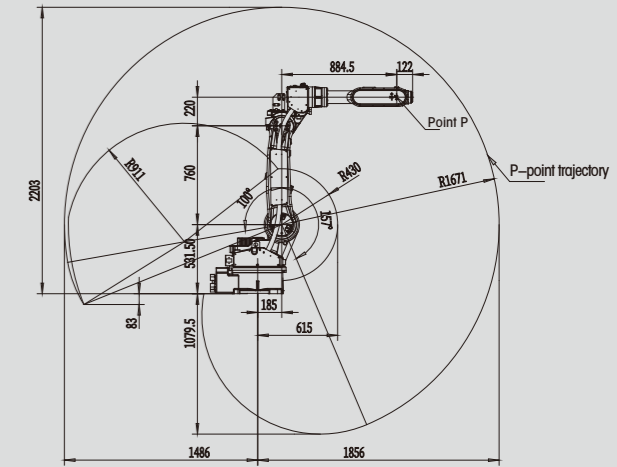

SF30-C1850 Wrist load torque chart

Note: The centre of gravity point of the load should be within the wrist torque diagram when in use

External & Installation Dimensions

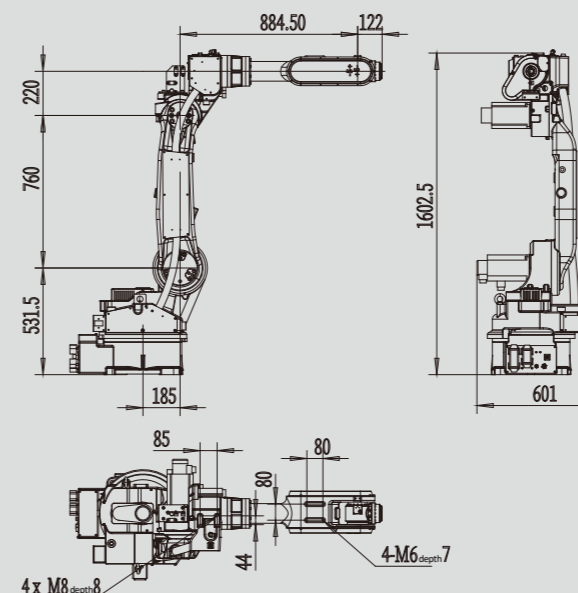

A-Way Diagram (End Flange Mounting Dimensions)

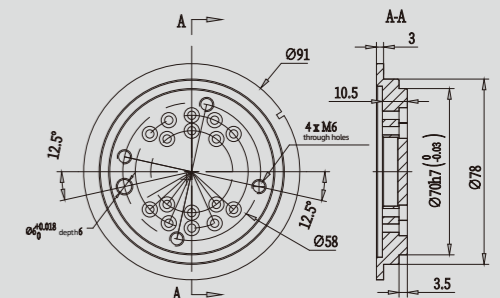

B-Way Diagram (Base Mounting Dimensions)

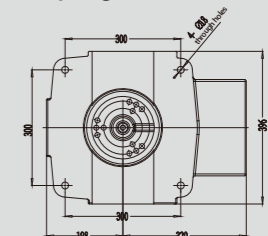

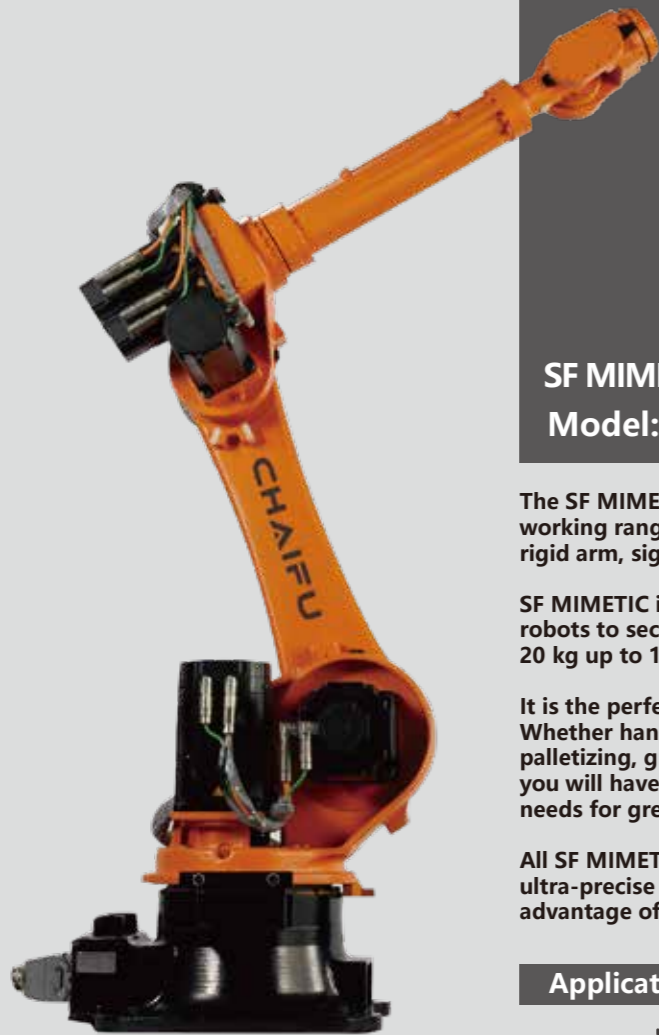

SF MIMETIC Series | Medium duty robot
Model: SF50 - K2178

The SF MIMETIC is a medium payload industrial robot with a superior working range, advanced servo control technology, and an extremely rigid arm, significantly reducing cycle times and ensuring high productivity.

SF MIMETIC is a complete solution for medium payload class industrial robots to secure your future planning and production investment. From 20 kg up to 120 kg of fine load breakdown.

It is the perfect solution to ensure accuracy and production quality. Whether handling, machine loading/unloading, painting, stamping, palletizing, grinding, picking/packing, or assembly/distribution. In addition, you will have the freedom to choose the robot corresponding to your actual needs for greater efficiency and economic benefits.

All SF MIMETIC series are equipped with LIKEPRECISION technology, the ultra-precise RV Precision Gearbox, which enables the robot to take full advantage of its advantages even at high operating speeds.

Applications

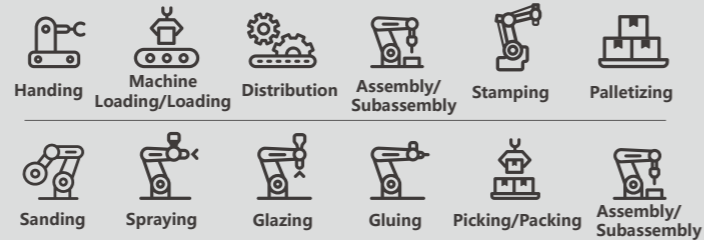

SF50-K2178 Data Overview

Model	SF50-K2178	
Structure	Vertically Articulated	
Number of Axis	6	
Radius	2178mm	
Payload	50kg	
Repeatability	±0.08mm	
Drive Mode	AC Servo Motor	
Maximum Speed	J1	125° /s
	J2	125° /s
	J3	140° /s
	J4	200° /s
	J5	210° /s
	J6	290° /s
Range of Motion	J1	±172°
	J2	+72° /-140°
	J3	+175° /-80°
	J4	±360°
	J5	±116°
	J6	±360°
Allowable Moment	J4	185N.M
	J5	185N.M
	J6	126N.M
Allowable Inertia	J4	12kg.m2
	J5	12kg.m2
	J6	9.6kg.m2
Protection Rating	IP 65	
Operating Conditions	Temp.	0-45°C
	Humidity	Below 95%RH
	Vibration	Below 4.9m/s2
	Other	Eliminate Signal Noise
Base Size	573*629mm	
Height	1778mm	
Weight	610KG	
Mounting Positions	Any angle	
Weight	5kVA	

SF50-K2178 Range of Motion

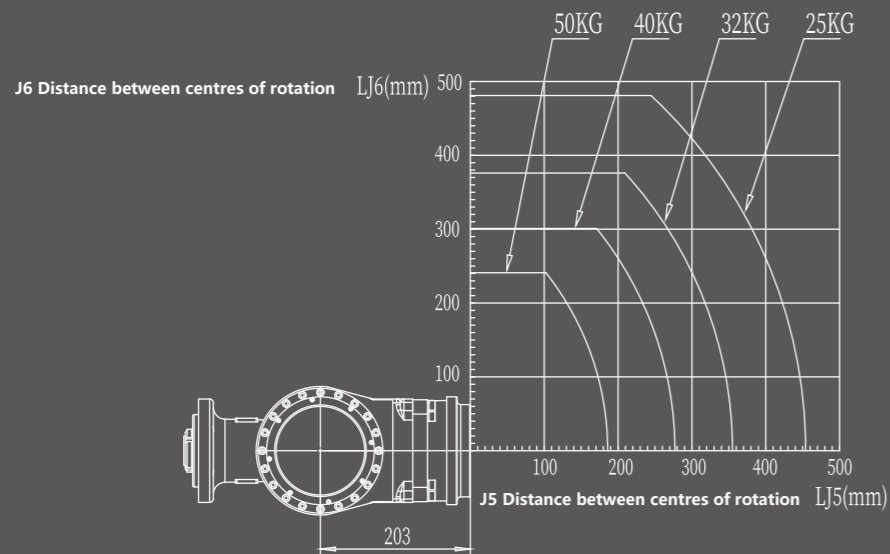
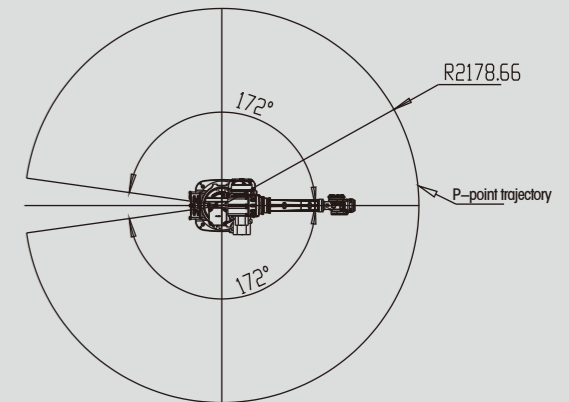
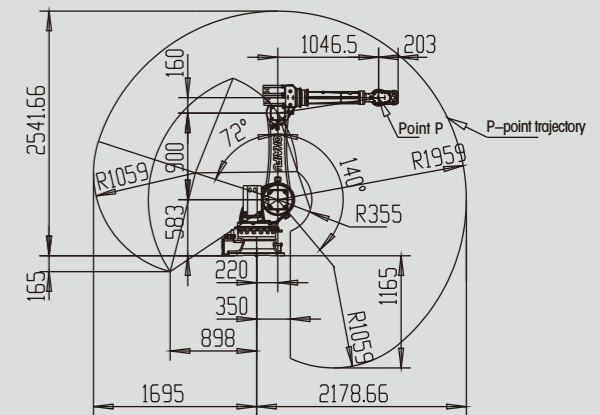

SF50-K2178 Wrist load torque chart

Note: The centre of gravity point of the load should be within the wrist torque diagram when in use

External & Installation Dimensions

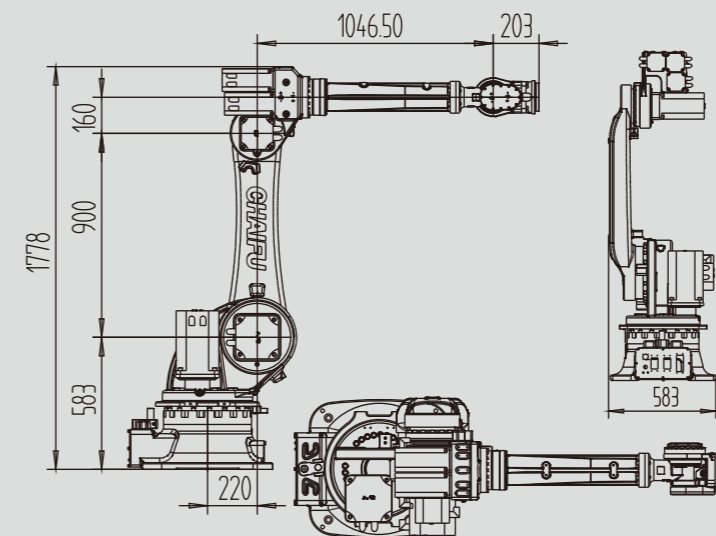

A-Way Diagram (End Flange Mounting Dimensions)

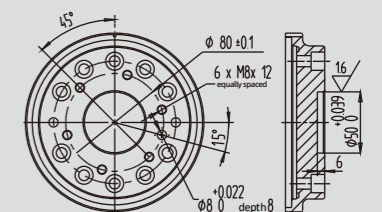

B-Way Diagram (Base Mounting Dimensions)

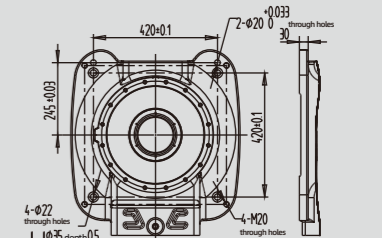



SF MIMETIC Series | Medium duty robot
Model: SF50 - C2185

The SF MIMETIC is a medium payload industrial robot with a superior working range, advanced servo control technology, and an extremely rigid arm, significantly reducing cycle times and ensuring high productivity.

SF MIMETIC is a complete solution for medium payload class industrial robots to secure your future planning and production investment. From 20 kg up to 120 kg of fine load breakdown.

It is the perfect solution to ensure accuracy and production quality. Whether handling, machine loading/unloading, painting, stamping, palletizing, grinding, picking/packing, or assembly/distribution. In addition, you will have the freedom to choose the robot corresponding to your actual needs for greater efficiency and economic benefits.

All SF MIMETIC series are equipped with LIKEPRECISION technology, the ultra-precise RV Precision Gearbox, which enables the robot to take full advantage of its advantages even at high operating speeds.

Applications

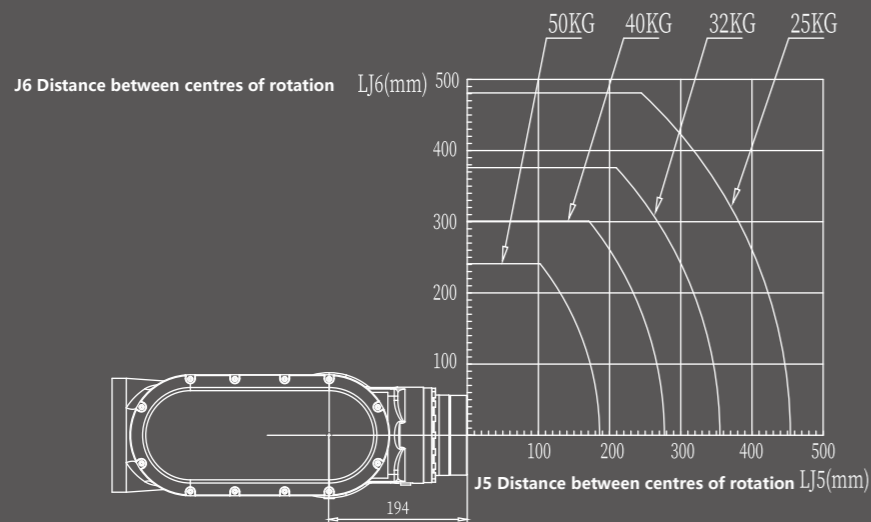
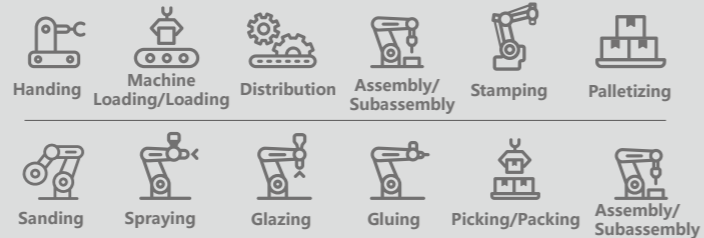

SF50-C2185 Wrist load torque chart

Note: The centre of gravity point of the load should be within the wrist torque diagram when in use

SF50-C2185 Data Overview

Model	SF50-C2185	
Structure	Vertically Articulated	
Number of Axis	6	
Radius	2185mm	
Payload	50kg	
Repeatability	±0.08mm	
Drive Mode	AC Servo Motor	
Maximum Speed	J1	109° /s
	J2	125° /s
	J3	140° /s
	J4	200° /s
	J5	210° /s
	J6	190° /s
Range of Motion	J1	±172°
	J2	+72° /-140°
	J3	+172° /-78°
	J4	±360°
	J5	+124° /-121°
	J6	±360°
Allowable Moment	J4	185N.M
	J5	185N.M
	J6	126N.M
Allowable Inertia	J4	12kg.m2
	J5	12kg.m2
	J6	9.6kg.m2
Protection Rating	IP 65	
Operating Conditions	Temp.	0-45°C
	Humidity	Below 95%RH
	Vibration	Below 4.9m/s2
	Other	Eliminate Signal Noise
Base Size	630*570mm	
Height	1820mm	
Weight	550KG	
Mounting Positions	Any angle	
Weight	5kVA	

SF50-C2185 Range of Motion

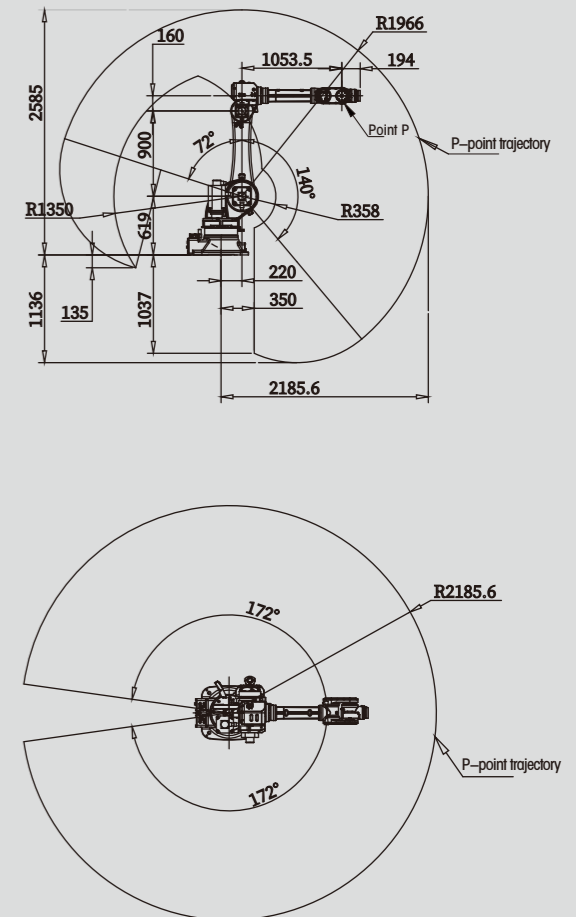

External & Installation Dimensions

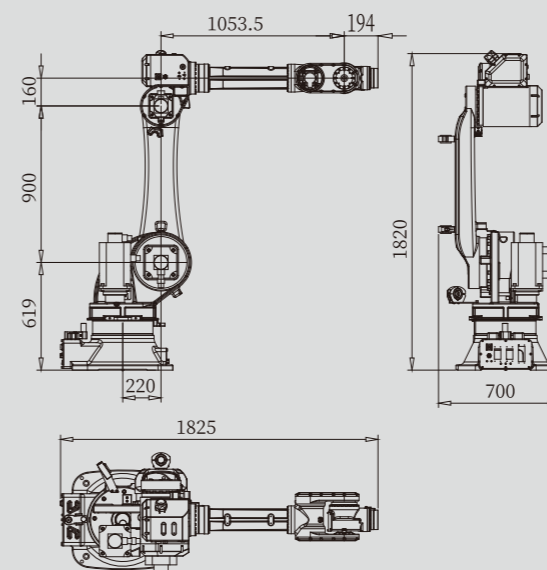

A-Way Diagram (End Flange Mounting Dimensions)

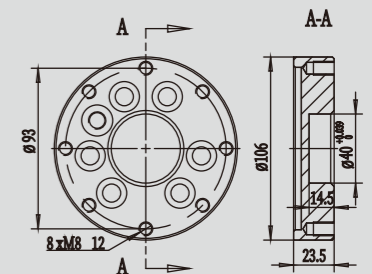

B-Way Diagram (Base Mounting Dimensions)

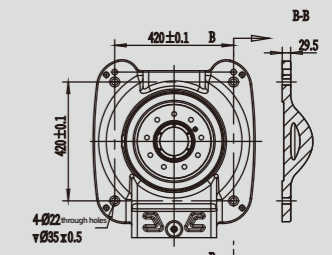



SF MIMETIC Series | Medium duty robot
Model: SF80 - C2600

The SF MIMETIC is a medium payload industrial robot with a superior working range, advanced servo control technology, and an extremely rigid arm, significantly reducing cycle times and ensuring high productivity.

SF MIMETIC is a complete solution for medium payload class industrial robots to secure your future planning and production investment. From 20 kg up to 120 kg of fine load breakdown.

It is the perfect solution to ensure accuracy and production quality. Whether handling, machine loading/unloading, painting, stamping, palletizing, grinding, picking/packing, or assembly/distribution. In addition, you will have the freedom to choose the robot corresponding to your actual needs for greater efficiency and economic benefits.

All SF MIMETIC series are equipped with LIKEPRECISION technology, the ultra-precise RV Precision Gearbox, which enables the robot to take full advantage of its advantages even at high operating speeds.

Applications

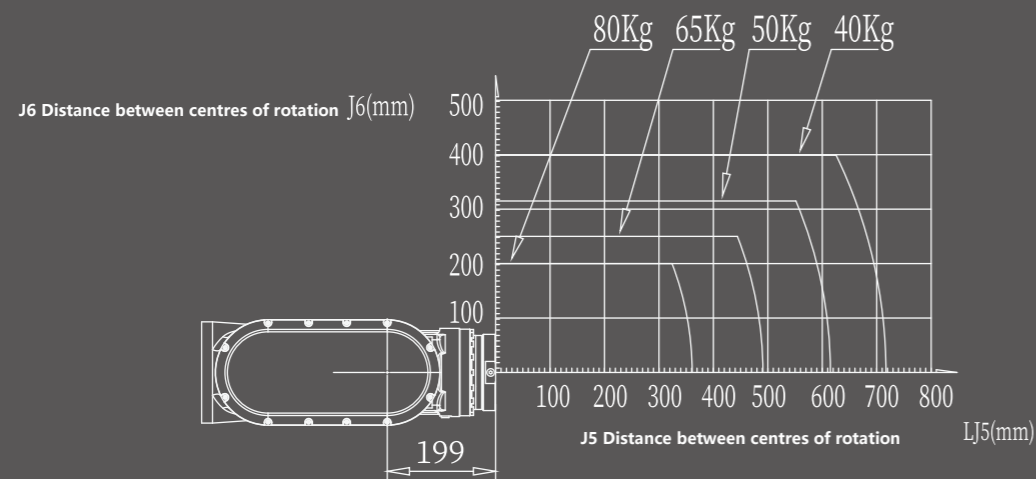

SF80-C2600 Wrist load torque chart

Note: The centre of gravity point of the load should be within the wrist torque diagram when in use

SF80-C2600 Data Overview

Model	SF80-C2600	
Structure	Vertically Articulated	
Number of Axis	6	
Radius	2600mm	
Payload	80kg	
Repeatability	±0.08mm	
Drive Mode	AC Servo Motor	
Maximum Speed	J1	160° /s
	J2	110° /s
	J3	120° /s
	J4	162° /s
	J5	180° /s
	J6	300° /s
Range of Motion	J1	±172°
	J2	+72° /-140°
	J3	+160° /-78°
	J4	±360°
	J5	+120°/-120°
	J6	±360°
Allowable Moment	J4	360N.M
	J5	360N.M
	J6	186N.M
Allowable Inertia	J4	52kg.m2
	J5	52kg.m2
	J6	26kg.m2
Protection Rating	IP 65	
Operating Conditions	Temp.	0-45°C
	Humidity	Below 95%RH
	Vibration	Below 4.9m/s2
	Other	Eliminate Signal Noise
Base Size	578*573mm	
Height	1898mm	
Weight	726KG	
Mounting Positions	Any angle	
Weight	5.5kVA	

SF80-C2600 Range of Motion

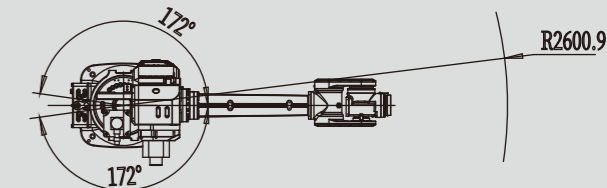
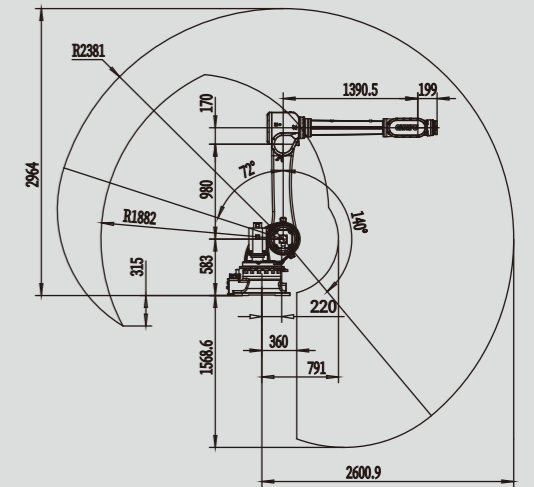

External & Installation Dimensions

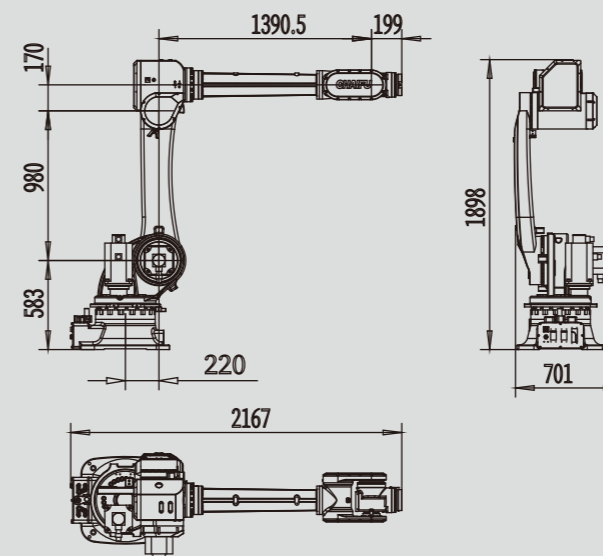

A-Way Diagram (End Flange Mounting Dimensions)

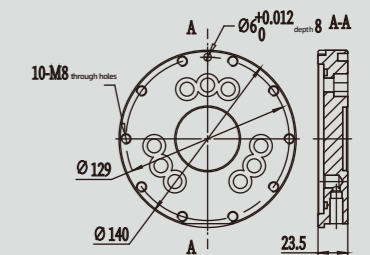

B-Way Diagram (Base Mounting Dimensions)

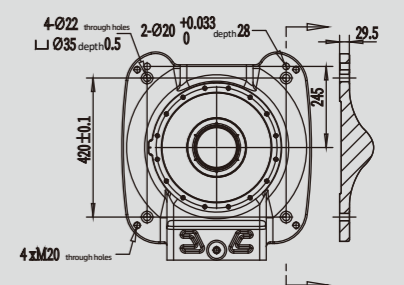



SF MIMETIC Series | Medium duty robot
Model: SF120 - C2269

The SF MIMETIC is a medium payload industrial robot with a superior working range, advanced servo control technology, and an extremely rigid arm, significantly reducing cycle times and ensuring high productivity.

SF MIMETIC is a complete solution for medium payload class industrial robots to secure your future planning and production investment. From 20 kg up to 120 kg of fine load breakdown.

It is the perfect solution to ensure accuracy and production quality. Whether handling, machine loading/unloading, painting, stamping, palletizing, grinding, picking/packing, or assembly/distribution. In addition, you will have the freedom to choose the robot corresponding to your actual needs for greater efficiency and economic benefits.

All SF MIMETIC series are equipped with LIKEPRECISION technology, the ultra-precise RV Precision Gearbox, which enables the robot to take full advantage of its advantages even at high operating speeds.

Applications

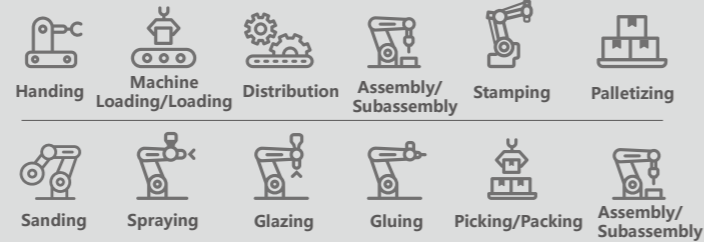

SF120-C2269 Data Overview

Model	SF120-C2269	
Structure	Vertically Articulated	
Number of Axis	6	
Radius	2269mm	
Payload	120kg	
Repeatability	±0.08mm	
Drive Mode	AC Servo Motor	
Maximum Speed	J1	160° /s
	J2	110° /s
	J3	120° /s
	J4	162° /s
	J5	180° /s
	J6	200° /s
Range of Motion	J1	±172°
	J2	+72° /-140°
	J3	+160° /-78°
	J4	±360°
	J5	+120°/-120°
	J6	±360°
Allowable Moment	J4	360N.M
	J5	360N.M
	J6	186N.M
Allowable Inertia	J4	52kg.m2
	J5	52kg.m2
	J6	26kg.m2
Protection Rating	IP 65	
Operating Conditions	Temp.	0-45°C
	Humidity	Below 95%RH
	Vibration	Below 4.9m/s2
	Other	Eliminate Signal Noise
Base Size	578*573mm	
Height	1939mm	
Weight	720KG	
Mounting Positions	Any angle	
Weight	5.5kVA	

SF120-C2269 Range of Motion

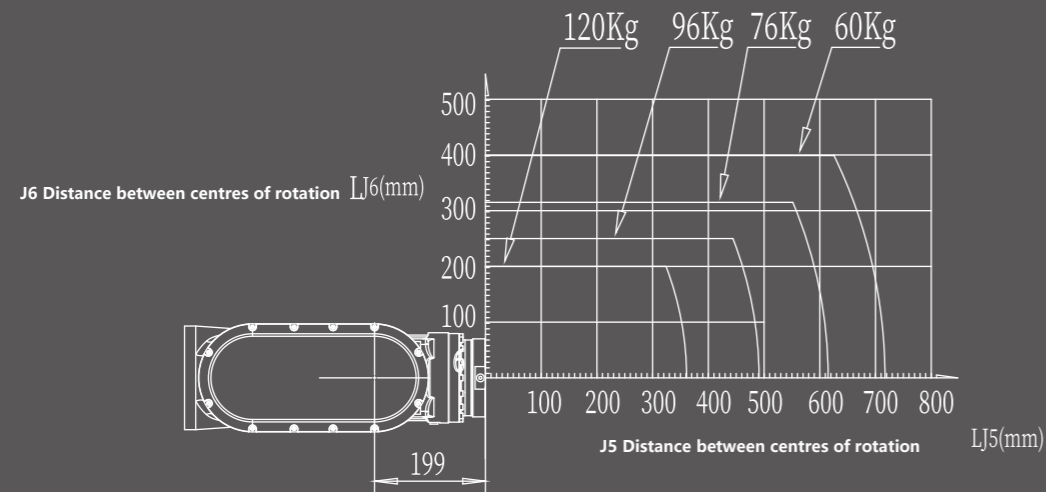
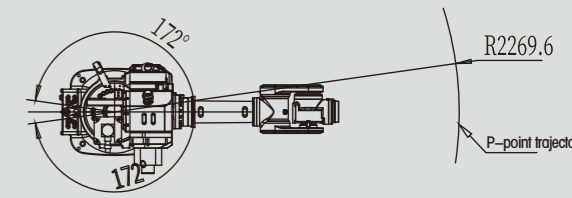
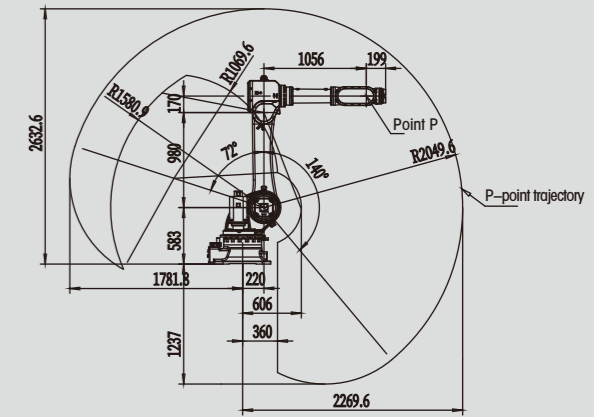

SF120-C2269 Wrist load torque chart

Note: The centre of gravity point of the load should be within the wrist torque diagram when in use

External & Installation Dimensions

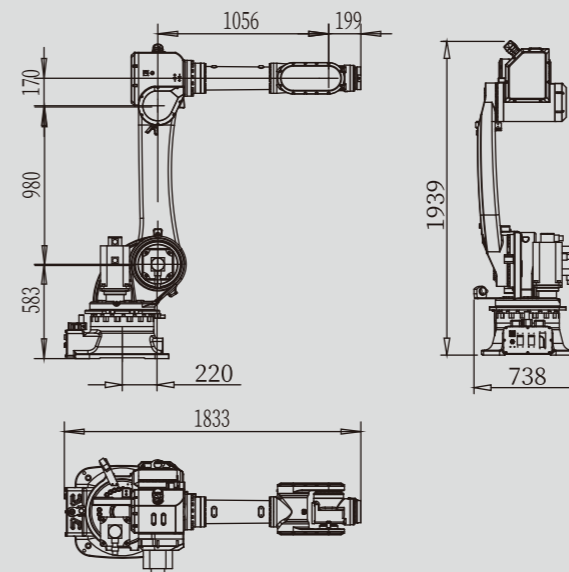

A-Way Diagram (End Flange Mounting Dimensions)

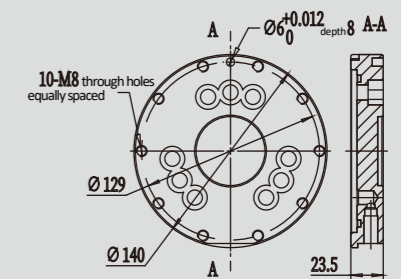

B-Way Diagram (Base Mounting Dimensions)

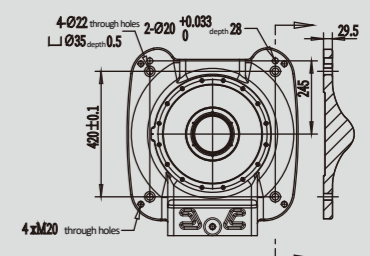



SF BIOTIC Series | High-Payload Robot Model: SF210 - K2650

The SF BIOTIC is a high-load class of industrial robots with lightweight construction and excellent control technology that significantly increases productivity per unit time. In addition, powerful drives and a wide range of optional configurations ensure,

The SF BIOTIC series stands proud in the high-load industrial sector. CHAIFU industrial robots offer flexible cost savings and high-performance solutions. It is ideally suited for tasks with loads up to 210 kg.

For this reason, it is particularly suitable for handling, palletizing, submerged arc welding, picking/packaging, and assembly/distribution applications. The performance is excellent in terms of space, availability, repeatability, and repeatability.

Applications

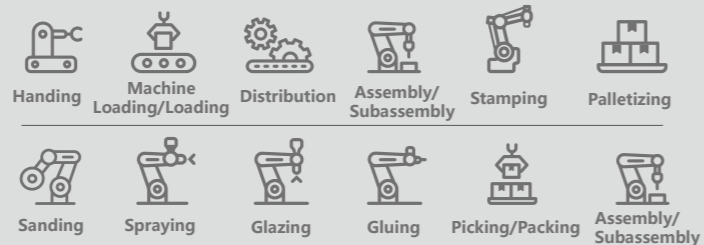

SF210-K2650 Data Overview

Model	SF210-K2650	
Structure	Vertically Articulated	
Number of Axis	6	
Radius	2643mm	
Payload	210kg	
Repeatability	±0.12mm	
Drive Mode	AC Servo Motor	
Maximum Speed	J1	110° /s
	J2	83° /s
	J3	99° /s
	J4	158° /s
	J5	206° /s
	J6	300° /s
Range of Motion	J1	±180°
	J2	+50° /-75°
	J3	+90° /-70°
	J4	±185°
	J5	±120°
	J6	±360°
Allowable Moment	J4	1301N.M
	J5	1301N.M
	J6	706N.M
Allowable Inertia	J4	138kg.m2
	J5	138kg.m2
	J6	70 kg.m2
Protection Rating	IP 65	
Operating Conditions	Temp.	0-45°C
	Humidity	Below 95%RH
	Vibration	Below 4.9m/s ²
	Other	Eliminate Signal Noise
Base Size	750*520mm	
Height	2257.5mm	
Weight	1460KG	
Mounting Positions	Floor	
Weight	7.5kVA	

SF210-K2650 Range of Motion

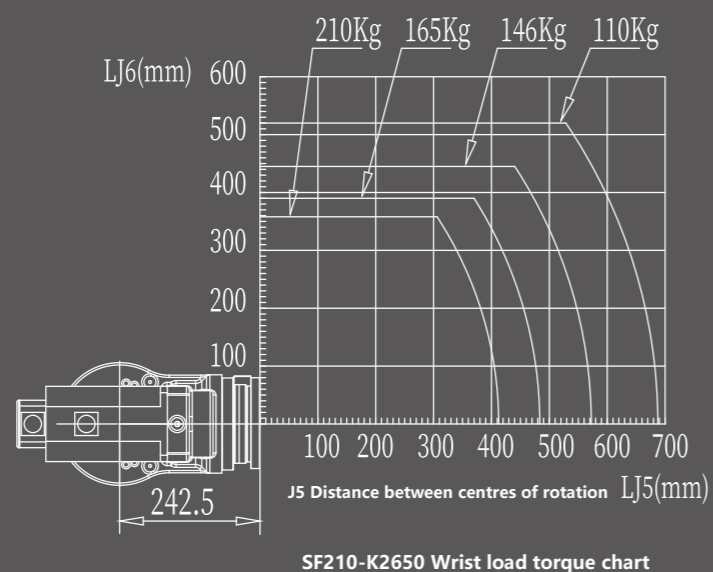
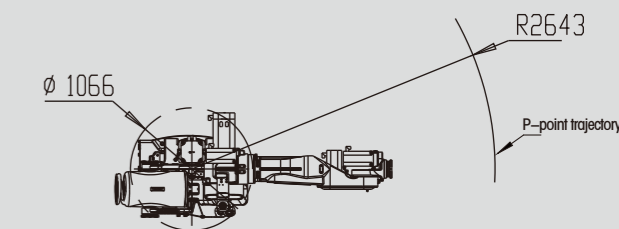
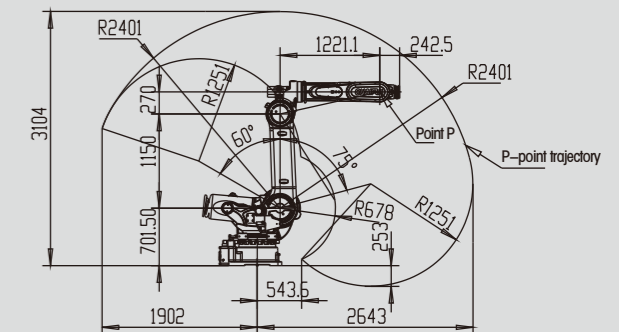

Note: The centre of gravity point of the load should be within the wrist torque diagram when in use

External & Installation Dimensions

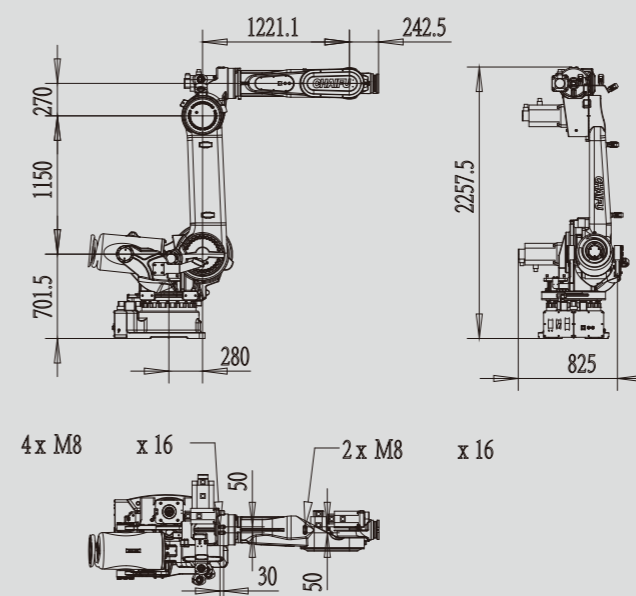

A-Way Diagram (End Flange Mounting Dimensions)

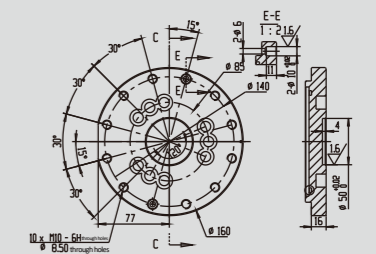

B-Way Diagram (Base Mounting Dimensions)

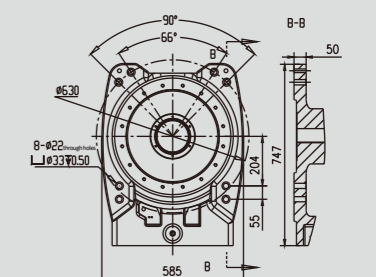

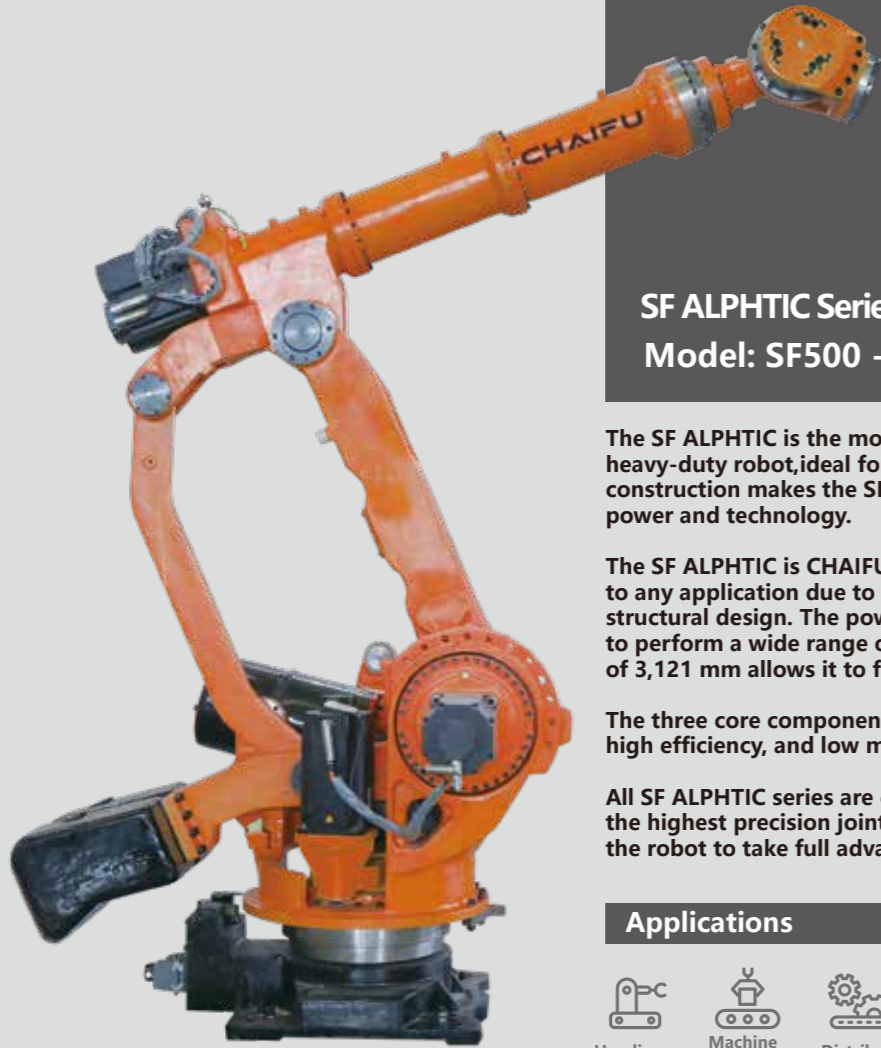

SF ALPHTIC Series | Heavy-Duty Robot Model: SF500 - C3100

The SF ALPHTIC is the most powerful and technologically advanced heavy-duty robot, ideal for large, high-load applications, and its construction makes the SF ALPHTIC the perfect combination of power and technology.

The SF ALPHTIC is CHAIFU's heavy-duty robot perfectly matched to any application due to its ultra-high craftsmanship and rugged structural design. The powerful motors and gearboxes are designed to perform a wide range of heavy-duty tasks. The long working stroke of 3,121 mm allows it to fit comfortably in small work cells.

The three core components of the CHAIFU convince with their low cost, high efficiency, and low maintenance, even in heavy-duty applications.

All SF ALPHTIC series are equipped with LIKEPRECISION technology and the highest precision joint part reducer, RV Reducer, which enables the robot to take full advantage of its advantages even in high-speed operation.

Applications

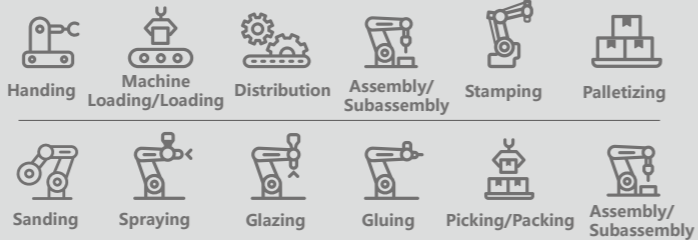

SF500-C3100 Data Overview

Model	SF500-C3100	
Structure	Vertically Articulated	
Number of Axis	6	
Radius	3121mm	
Payload	500kg	
Repeatability	±0.3mm	
Drive Mode	AC Servo Motor	
Maximum Speed	J1	100° /s
	J2	85° /s
	J3	85° /s
	J4	80° /s
	J5	80° /s
	J6	160° /s
Range of Motion	J1	±180°
	J2	+50° /-85°
	J3	-120° /+25°
	J4	±360°
	J5	±115°
	J6	±360°
Allowable Moment	J4	1980N.M
	J5	1980N.M
	J6	865N.M
Allowable Inertia	J4	152kg.m2
	J5	152kg.m2
	J6	122kg.m2
Protection Rating	IP 65, Wrist IP 67	
Operating Conditions	Temp.	0-45°C
	Humidity	Below 95%RH
	Vibration	Below 4.9m/s2
	Other	Eliminate Signal Noise
Base Size	910*739mm	
Height	2695mm	
Weight	2780KG	
Mounting Positions	Floor	
Weight	9.5kVA	

SF500-C3100 Range of Motion

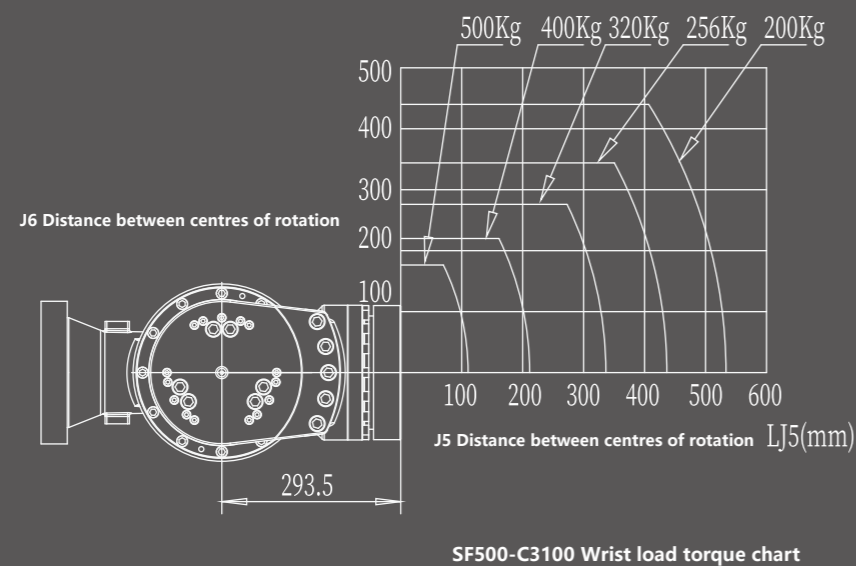
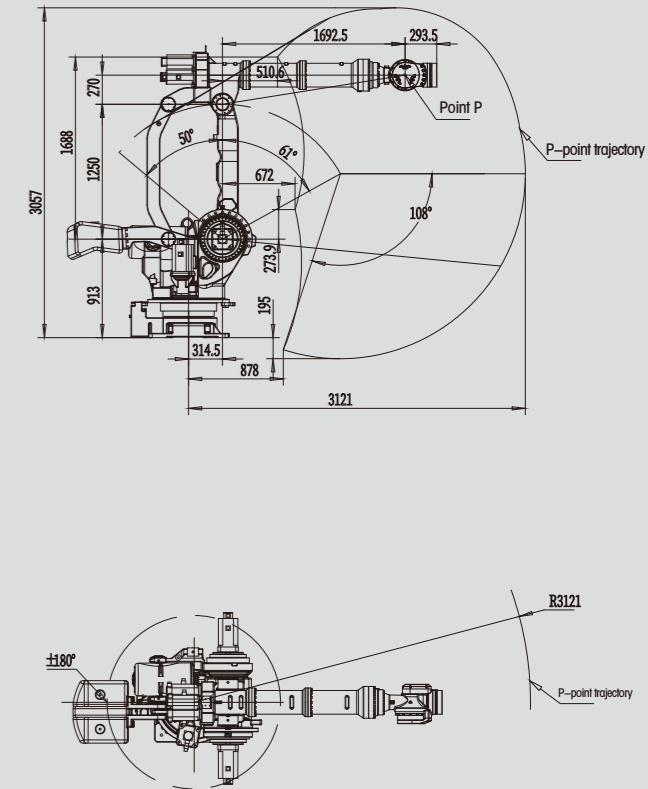

Note: The centre of gravity point of the load should be within the wrist torque diagram when in use

External & Installation Dimensions

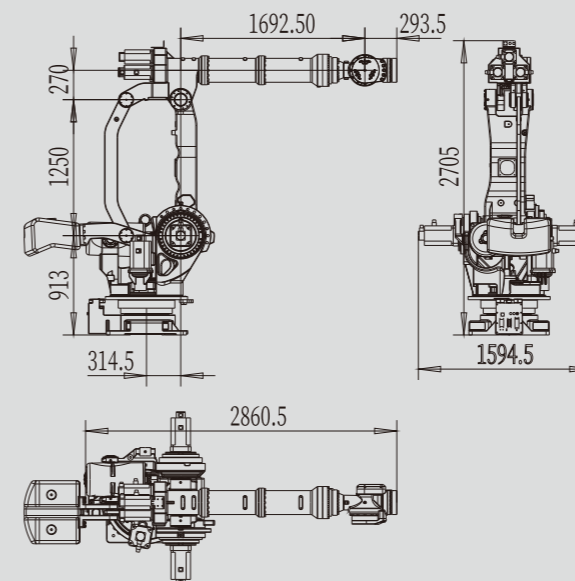

A-Way Diagram (End Flange Mounting Dimensions)

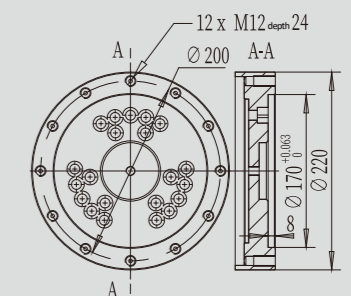

B-Way Diagram (Base Mounting Dimensions)

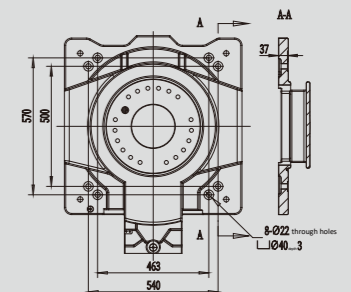



SF PRESS Series | Stamping Press Robot Model: SF8 - K1400

The SF PRESS is designed for high speed press handling. With its high precision and unmatched productivity, the SF PRESS has become the best productivity tool for press handling loading and palletizing.

The SF PRESS pin optimizes the efficiency and productivity of the overall press shop, with different combinations for different applications and a solid foundation for every press command due to LIKEHEATTREATMENT thermal technology.

All SF PRESS series are equipped with LIKEPRECISION technology, the ultra-precise RV Precision Gearbox, which allows the robot to take full advantage of its advantages even at high operating speeds.

Applications

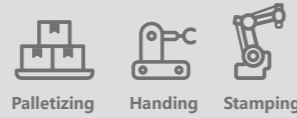

Palletizing Handing Stamping

SF8-K1400 Data Overview

Model	SF8-K1400	
Structure	Vertically Articulated	
Number of Axis	4	
Radius	1492mm	
Payload	8kg	
Repeatability	±0.05mm	
Drive Mode	AC Servo Motor	
Maximum Speed	J1	150° /s
	J2	148° /s
	J3	195° /s
	J4	265° /s
	J5	/
	J6	/
Range of Motion	J1	±160°
	J2	+40° /-85°
	J3	+35° /-70°
	J4	±360°
	J5	/
	J6	/
Allowable Moment	J4	28N.M
	J5	/
	J6	/
Allowable Inertia	J4	0.52kg.m2
	J5	/
	J6	/
Protection Rating	IP 65, Wrist IP 67	
Operating Conditions	Temp.	0-45°C
	Humidity	Below 95%RH
	Vibration	Below 4.9m/s2
	Other	Eliminate Signal Noise
Base Size	342*342mm	
Height	1200mm	
Weight	132KG	
Mounting Positions	Any angle	
Weight	2kVA	

SF8-K1400 Range of Motion

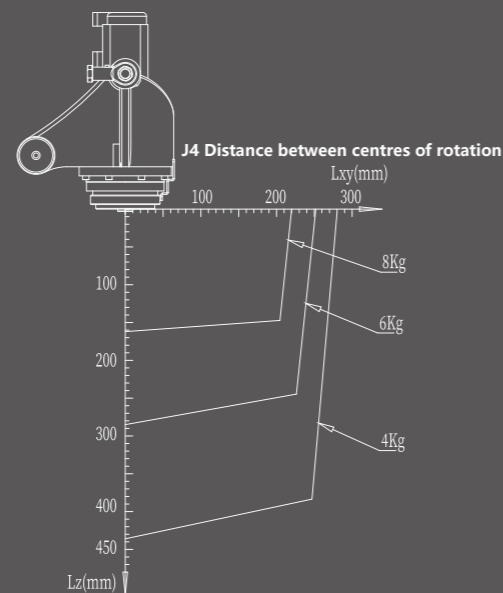
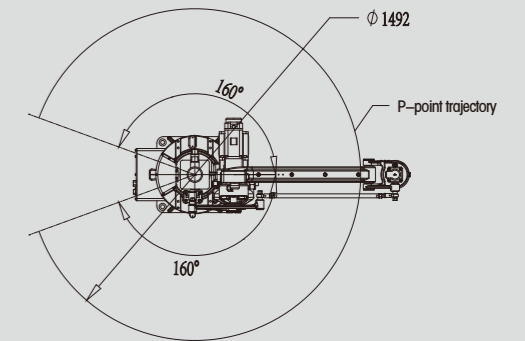
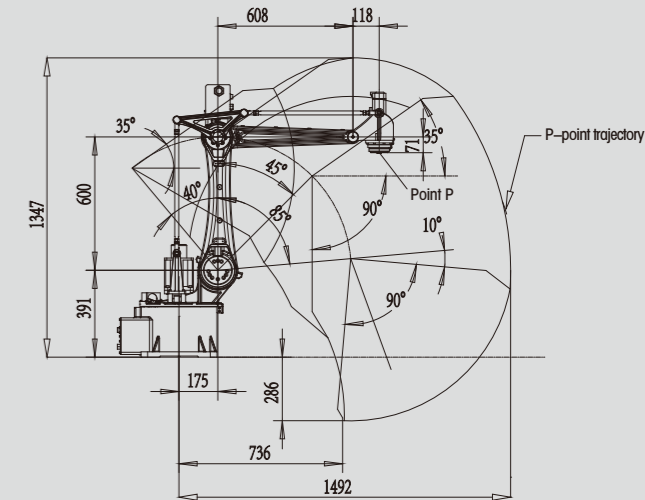

SF8-K1400 Wrist load torque chart

External & Installation Dimensions

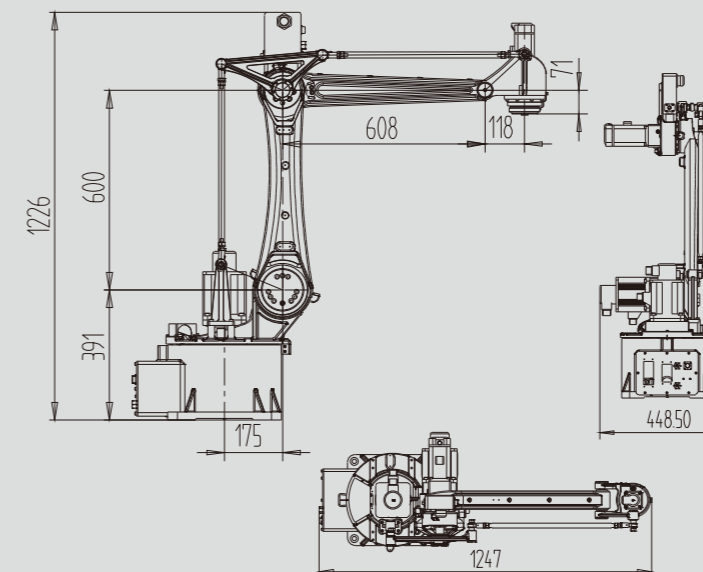

A-Way Diagram (End Flange Mounting Dimensions)

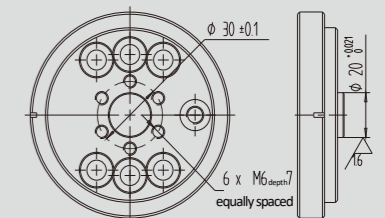

B-Way Diagram (Base Mounting Dimensions)

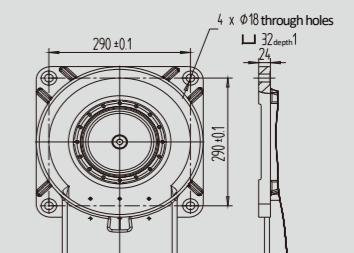



SF PRESS Series | Stamping Press Robot Model: SF15 - C1538

The SF PRESS is designed for high speed press handling. With its high precision and unmatched productivity, the SF PRESS has become the best productivity tool for press handling loading and palletizing.

The SF PRESS pin optimizes the efficiency and productivity of the overall press shop, with different combinations for different applications and a solid foundation for every press command due to LIKEHEATTREATMENT thermal technology.

All SF PRESS series are equipped with LIKEPRECISION technology, the ultra-precise RV Precision Gearbox, which allows the robot to take full advantage of its advantages even at high operating speeds.

Applications

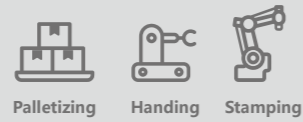

Palletizing Handing Stamping

SF15-C1538 Data Overview

Model	SF15-C1538	
Structure	Vertically Articulated	
Number of Axis	4	
Radius	1538mm	
Payload	15kg	
Repeatability	±0.06mm	
Drive Mode	AC Servo Motor	
Maximum Speed	J1	150° /s
	J2	150° /s
	J3	160° /s
	J4	300° /s
	J5	/
	J6	/
Range of Motion	J1	±165°
	J2	+40° /-82°
	J3	+78° /-75°
	J4	±360°
	J2 + J3	-100°≤J2+J3≤+30°
Allowable Moment	J4	196N.M
	J5	/
	J6	/
Allowable Inertia	J4	0.52kg.m ²
	J5	/
	J6	/
Protection Rating	IP 65, Wrist IP 67	
Operating Conditions	Temp.	0-45°C
	Humidity	Below 95%RH
	Vibration	Below 4.9m/s ²
Other	Eliminate Signal Noise	
Base Size	384*384mm	
Height	1421mm	
Weight	181KG	
Mounting Positions	Any angle	
Weight	2.5kVA	

SF15-C1538 Range of Motion

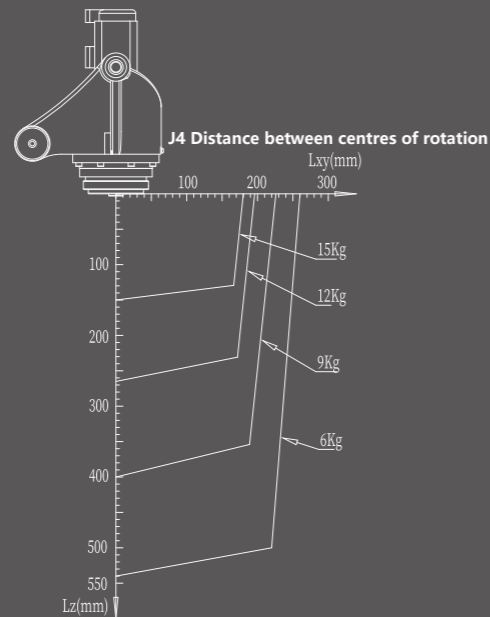
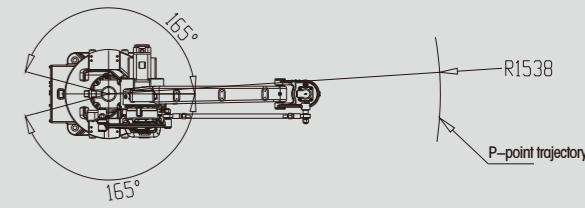
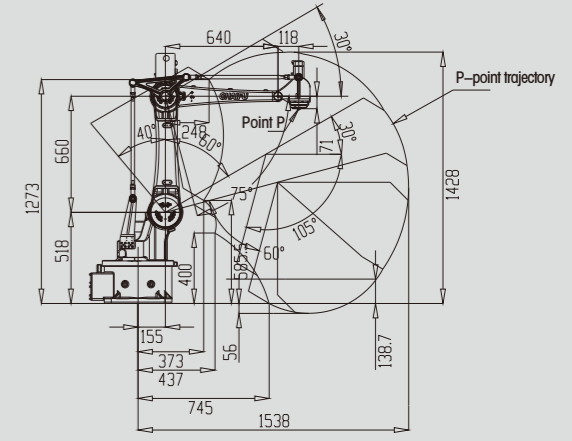

SF15-C1538 Wrist load torque chart

External & Installation Dimensions

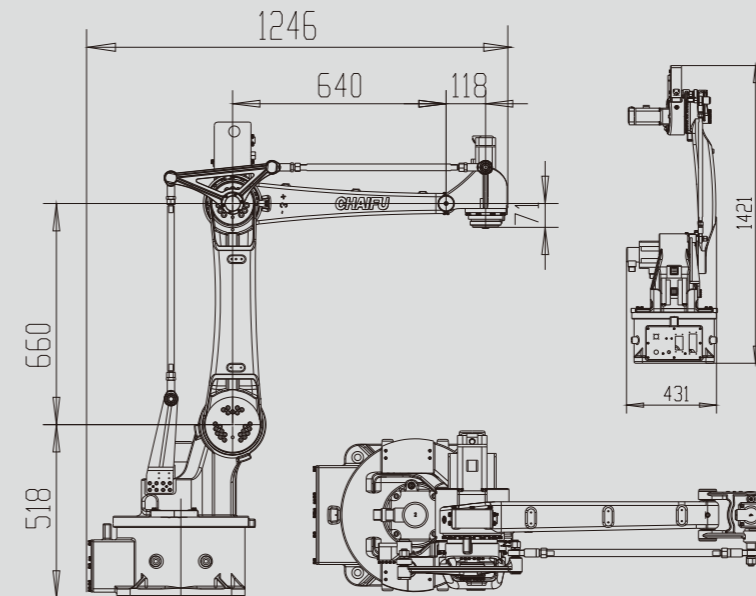

A-Way Diagram (End Flange Mounting Dimensions)

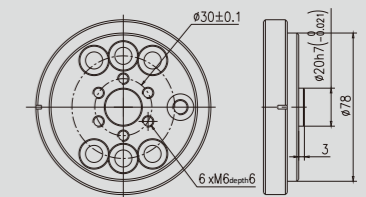

B-Way Diagram (Base Mounting Dimensions)

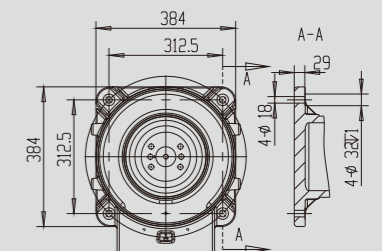



SF PRESS Series | Stamping Press Robot
Model: SF25 - C1760

The SF PRESS is designed for high speed press handling. With its high precision and unmatched productivity, the SF PRESS has become the best productivity tool for press handling loading and palletizing.

The SF PRESS pin optimizes the efficiency and productivity of the overall press shop, with different combinations for different applications and a solid foundation for every press command due to LIKEHEATTREATMENT thermal technology.

All SF PRESS series are equipped with LIKEPRECISION technology, the ultra-precise RV Precision Gearbox, which allows the robot to take full advantage of its advantages even at high operating speeds.

Applications

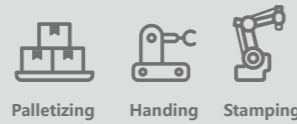

Palletizing Handing Stamping

SF25-C1760 Data Overview

Model	SF25-C1760	
Structure	Vertically Articulated	
Number of Axis	4	
Radius	1772mm	
Payload	25kg	
Repeatability	±0.07mm	
Drive Mode	AC Servo Motor	
Maximum Speed	J1	130° /s
	J2	107° /s
	J3	135° /s
	J4	175° /s
	J5	/
	J6	/
Range of Motion	J1	±175°
	J2	+48° /-95°
	J3	+80° /-75°
	J4	±360°
	J2 + J3	-110° ≤ J2+J3 ≤ +40°
Allowable Moment	J4	882N.M
	J5	/
	J6	/
Allowable Inertia	J4	0.62kg.m2
	J5	/
	J6	/
Protection Rating	IP 65, Wrist IP 67	
Operating Conditions	Temp.	0-45°C
	Humidity	Below 95%RH
	Vibration	Below 4.9m/s2
Other	Eliminate Signal Noise	
Base Size	370*370mm	
Height	1458mm	
Weight	260KG	
Mounting Positions	Any angle	
Weight	3kVA	

SF25-C1760 Range of Motion

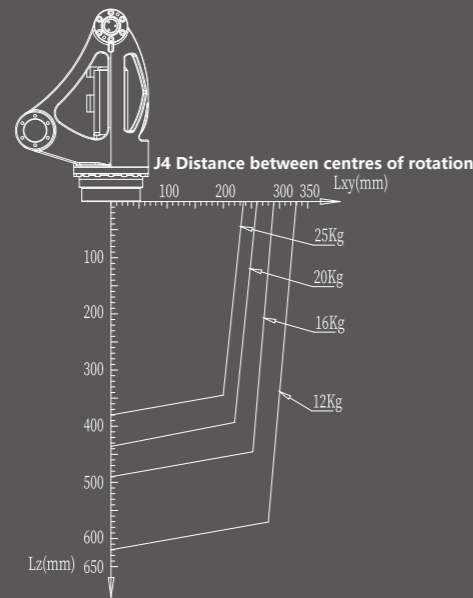
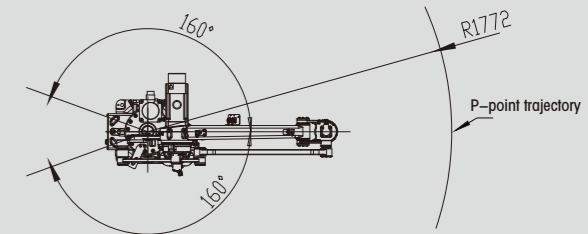
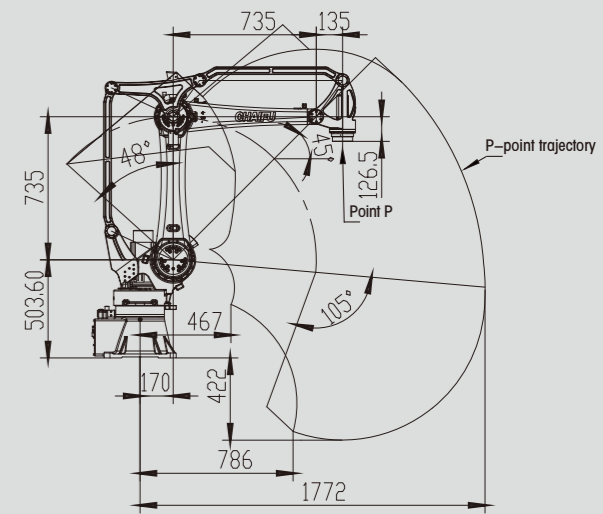

SF25-C1760 Wrist load torque chart

External & Installation Dimensions

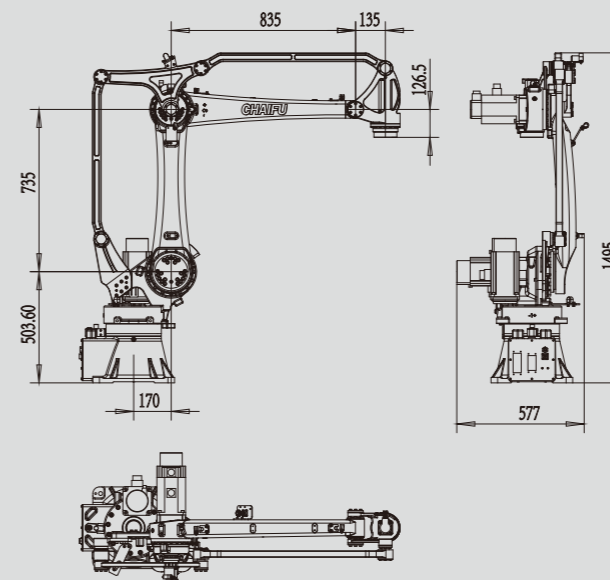

A-Way Diagram (End Flange Mounting Dimensions)

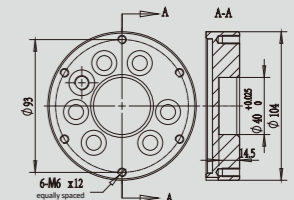

B-Way Diagram (Base Mounting Dimensions)

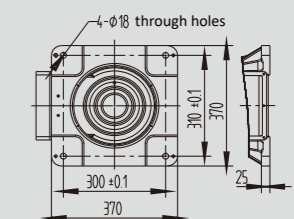



SF PRESS Series | Stamping Press Robot
Model: SF25 - C1900

The SF PRESS is designed for high speed press handling. With its high precision and unmatched productivity, the SF PRESS has become the best productivity tool for press handling loading and palletizing.

The SF PRESS pin optimizes the efficiency and productivity of the overall press shop, with different combinations for different applications and a solid foundation for every press command due to LIKEHEATTREATMENT thermal technology.

All SF PRESS series are equipped with LIKEPRECISION technology, the ultra-precise RV Precision Gearbox, which allows the robot to take full advantage of its advantages even at high operating speeds.

Applications

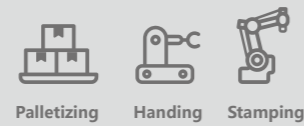

Palletizing Handing Stamping

SF25-C1900 Data Overview

Model	SF25-C1900	
Structure	Vertically Articulated	
Number of Axis	4	
Radius	1900mm	
Payload	25kg	
Repeatability	±0.08mm	
Drive Mode	AC Servo Motor	
Maximum Speed	J1	130° /s
	J2	107° /s
	J3	135° /s
	J4	175° /s
	J5	/
	J6	/
Range of Motion	J1	±175°
	J2	+48° /-95°
	J3	+50° /-75°
	J2 + J3	-110°≤J2+J3≤+50°
Allowable Moment	J4	882N.M
	J5	/
	J6	/
Allowable Inertia	J4	0.62kg.m2
	J5	/
	J6	/
Protection Rating	IP 65, Wrist IP 67	
Operating Conditions	Temp.	0-45°C
	Humidity	Below 95%RH
	Vibration	Below 4.9m/s2
	Other	Eliminate Signal Noise
Base Size	370*370mm	
Height	1495mm	
Weight	262.5KG	
Mounting Positions	Any angle	
Weight	3kVA	

SF25-C1900 Range of Motion

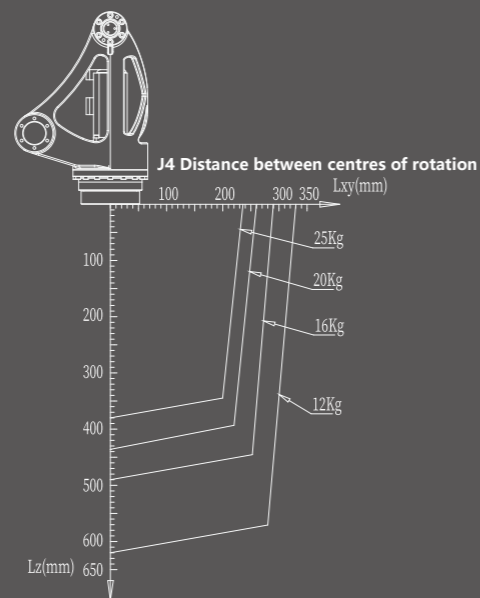
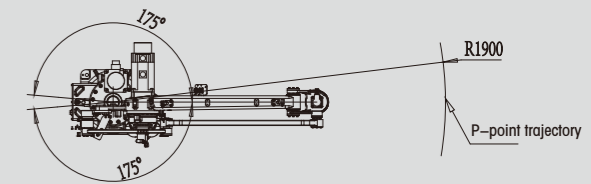
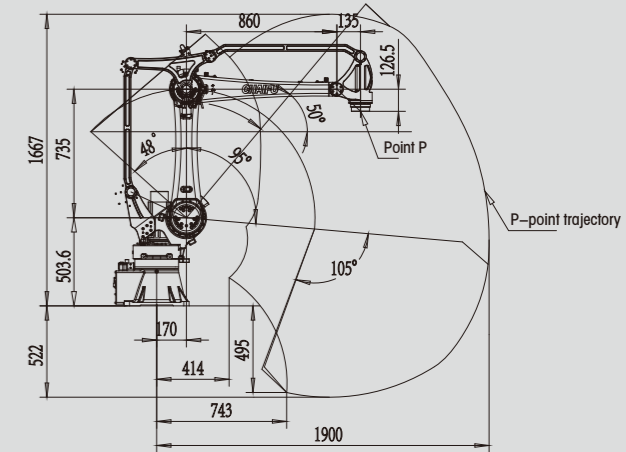

SF25-C1900 Wrist load torque chart

External & Installation Dimensions

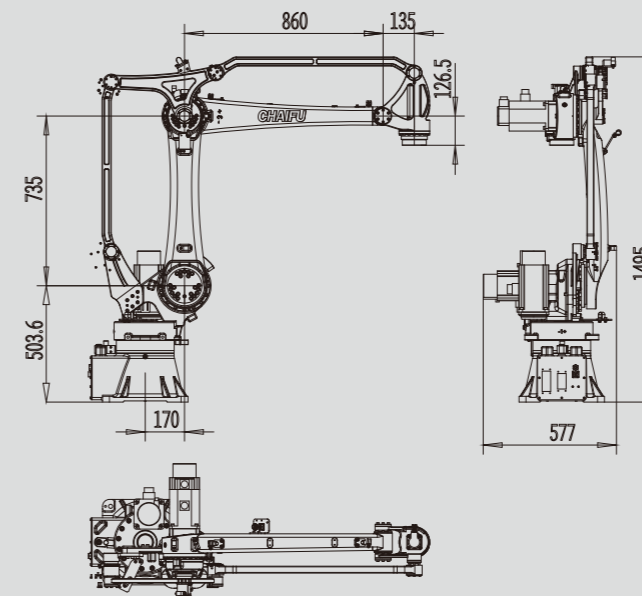

A-Way Diagram (End Flange Mounting Dimensions)

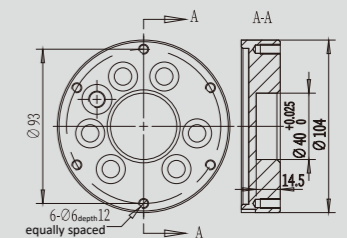

B-Way Diagram (Base Mounting Dimensions)

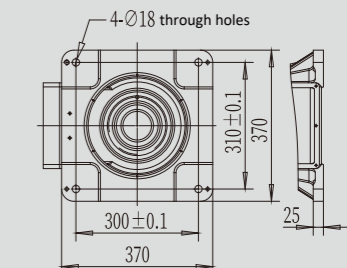



SF PA Series | Palletizing Robot
Model: SF50 - C2220

The SF PA series is fast, accurate, and powerful CHAIFU industrial robots for pallet stacking on the market. A complete product portfolio obtains higher economic benefits, high precision, low cost, and very efficient productivity.

The SF PA series for palletizing, handling, and stamping industrial applications offers unparalleled productivity and high performance in the market, completing a wide range of complete solutions quickly and precisely, with a low deadweight design to reduce cycle times.

With its low cost and high productivity, the SF PA is the perfect choice to benefit from the efficiency of your plant by achieving a total capacity increase with fast and accurate output in a small space.

Applications

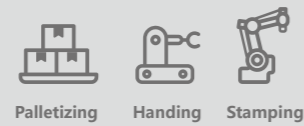

SF50-C2220 Data Overview

Model	SF50-C2220	
Structure	Vertically Articulated	
Number of Axis	4	
Radius	2216mm	
Payload	50kg	
Repeatability	±0.2mm	
Drive Mode	AC Servo Motor	
Maximum Speed	J1	125° /s
	J2	125° /s
	J3	140° /s
	J4	200° /s
	J5	/
	J6	/
Range of Motion	J1	±178°
	J2	+50° /-95°
	J3	+85° /-72°
	J4	±360°
	J2 + J3	-115°≤J2+J3≤+25°
Allowable Moment	J4	1666N.M
	J5	/
	J6	/
Allowable Inertia	J4	9.6kg.m2
	J5	/
	J6	/
Protection Rating	IP 65, Wrist IP 67	
Operating Conditions	Temp.	0-45°C
	Humidity	Below 95%RH
	Vibration	Below 4.9m/s2
	Other	Eliminate Signal Noise
Base Size	280*362mm	
Height	1755mm	
Weight	616KG	
Mounting Positions	Floor	
Weight	4kVA	

SF50-C2220 Range of Motion

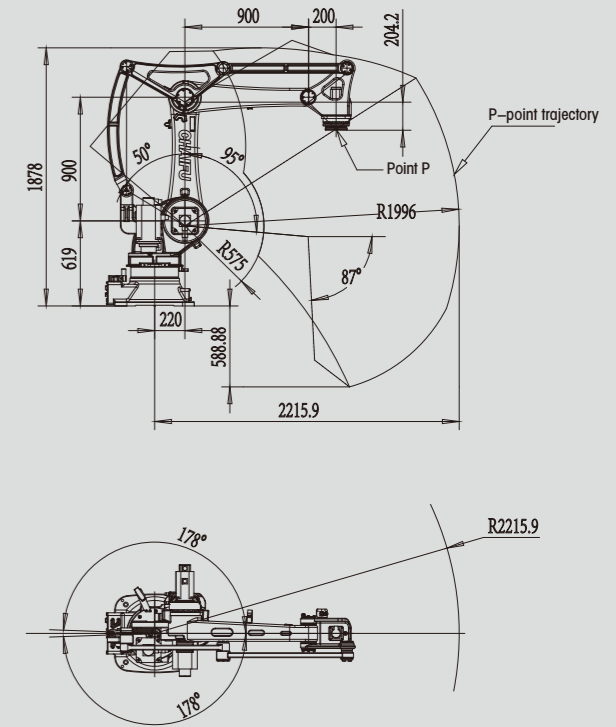

External & Installation Dimensions

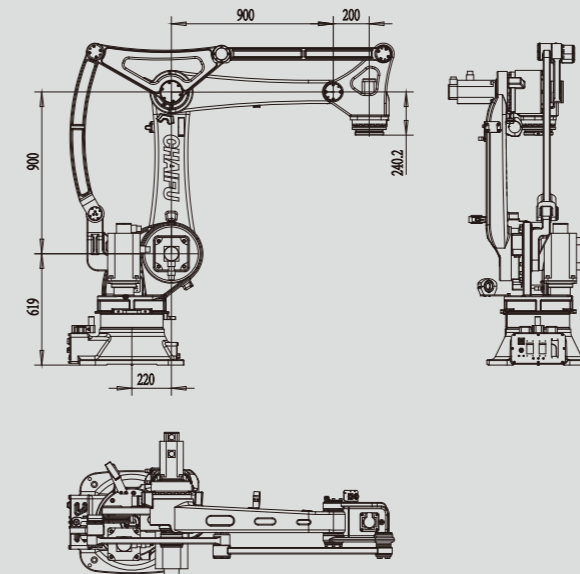

A-Way Diagram (End Flange Mounting Dimensions)

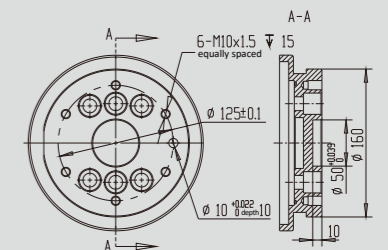

B-Way Diagram (Base Mounting Dimensions)

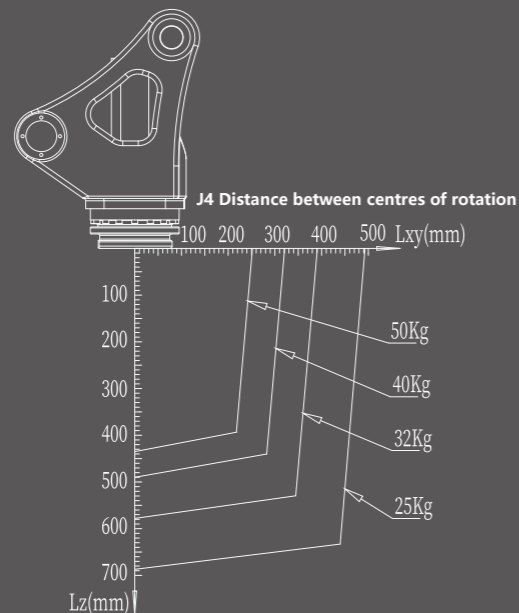
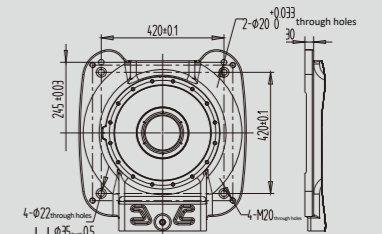

SF50-C2220 Wrist load torque chart



SF PA Series | Palletizing Robot Model: SF130 - K2700

The SF PA series is fast, accurate, and powerful CHAIFU industrial robots for pallet stacking on the market. A complete product portfolio obtains higher economic benefits, high precision, low cost, and very efficient productivity.

The SF PA series for palletizing, handling, and stamping industrial applications offers unparalleled productivity and high performance in the market, completing a wide range of complete solutions quickly and precisely, with a low deadweight design to reduce cycle times.

With its low cost and high productivity, the SF PA is the perfect choice to benefit from the efficiency of your plant by achieving a total capacity increase with fast and accurate output in a small space.

Applications

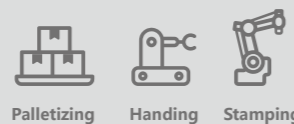

Palletizing Handling Stamping

SF130-K2700 Data Overview

Model	SF130-K2700	
Structure	Vertically Articulated	
Number of Axis	4	
Radius	2735mm	
Payload	130kg	
Repeatability	±0.25mm	
Drive Mode	AC Servo Motor	
Maximum Speed	J1	178° /s
	J2	112° /s
	J3	105° /s
	J4	340° /s
	J5	/
	J6	/
Range of Motion	J1	+/-180°
	J2	+45° /-90°
	J3	+85° /-55°
	J4	±360°
	J2 + J3	-105° ≤ J2 + J3 ≤ 25°
Allowable Moment	J4	1764N.M
	J5	/
	J6	/
Allowable Inertia	J4	36kg.m ²
	J5	/
	J6	/
Protection Rating	IP 65, Wrist IP 67	
Operating Conditions	Temp.	0-45°C
	Humidity	Below 95%RH
	Vibration	Below 4.9m/s ²
	Other	Eliminate Signal Noise
Base Size	620*620mm	
Height	2073mm	
Weight	1160KG	
Mounting Positions	Floor	
Weight	5.5kVA	

SF130-K2700 Range of Motion

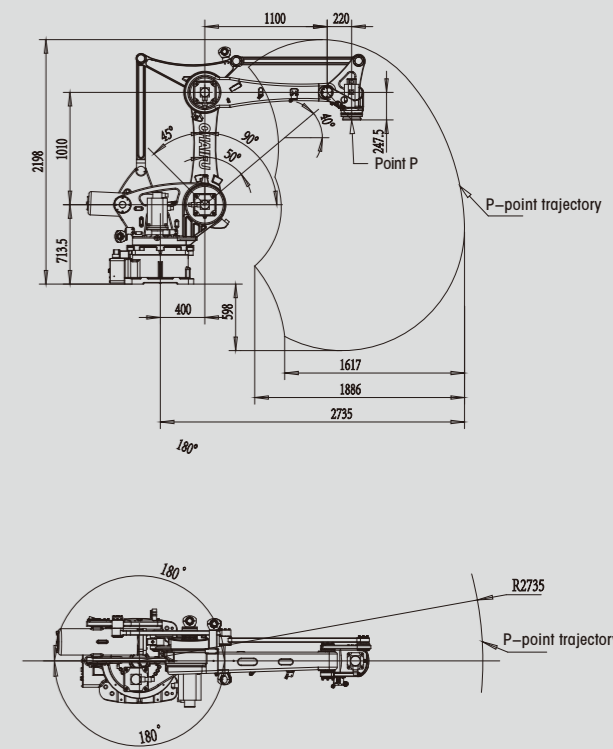

External & Installation Dimensions

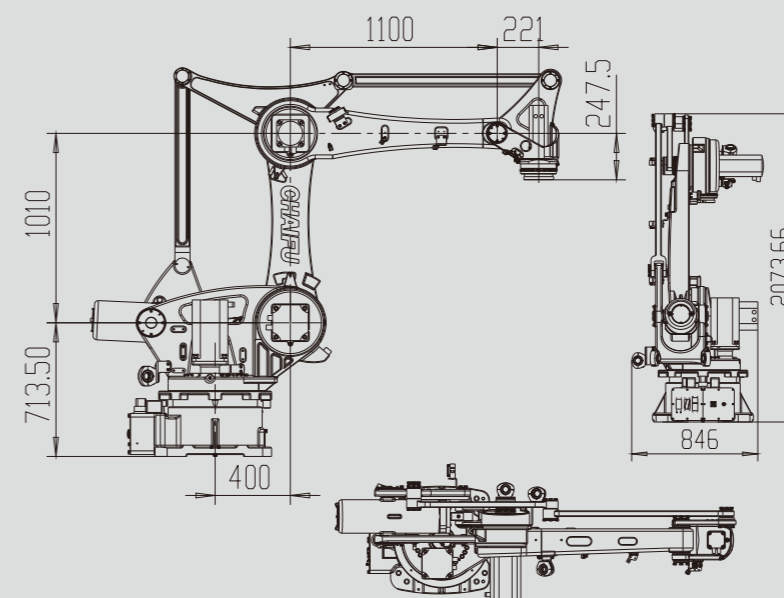

A-Way Diagram (End Flange Mounting Dimensions)

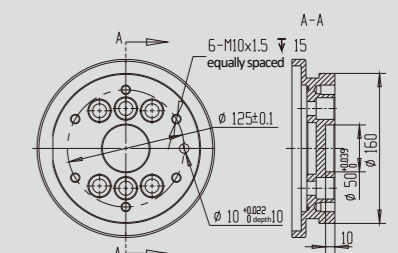

B-Way Diagram (Base Mounting Dimensions)

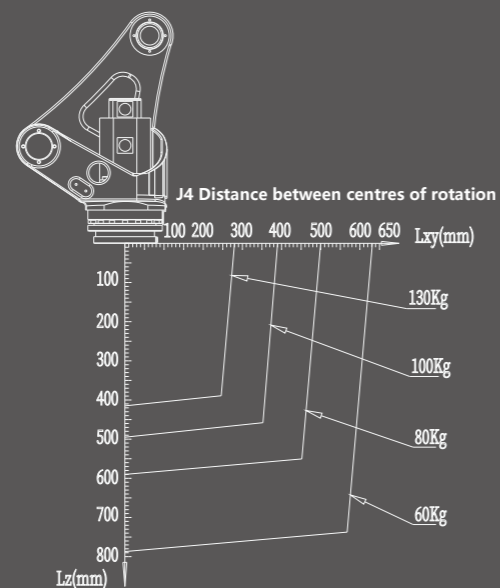
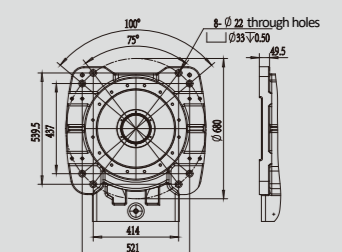

SF130-K2700 Wrist load torque chart



SF PA Series | Palletizing Robot
Model: SF180 - C3200

The SF PA series is fast, accurate, and powerful CHAIFU industrial robots for pallet stacking on the market. A complete product portfolio obtains higher economic benefits, high precision, low cost, and very efficient productivity.

The SF PA series for palletizing, handling, and stamping industrial applications offers unparalleled productivity and high performance in the market, completing a wide range of complete solutions quickly and precisely, with a low deadweight design to reduce cycle times.

With its low cost and high productivity, the SF PA is the perfect choice to benefit from the efficiency of your plant by achieving a total capacity increase with fast and accurate output in a small space.

Applications

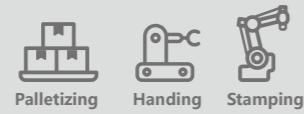

SF180-C3200 Data Overview

Model	SF180-C3200	
Structure	Vertically Articulated	
Number of Axis	4	
Radius	3245.5mm	
Payload	180kg	
Repeatability	±0.25mm	
Drive Mode	AC Servo Motor	
Maximum Speed	J1	110° /s
	J2	112° /s
	J3	105° /s
	J4	260° /s
	J5	/
	J6	/
Range of Motion	J1	±180°
	J2	-90° /+50°
	J3	-75° /+110°
	J4	±360°
	J2 + J3	-115° ≤ J2 + J3 ≤ 22.5°
Allowable Moment	J4	1764N.M
	J5	/
	J6	/
Allowable Inertia	J4	36kg.m ²
	J5	/
	J6	/
Protection Rating	IP 65, Wrist IP 67	
Operating Conditions	Temp.	0-45°C
	Humidity	Below 95%RH
	Vibration	Below 4.9m/s ²
	Other	Eliminate Signal Noise
Base Size	750*520mm	
Height	2401mm	
Weight	1380KG	
Mounting Positions	Floor	
Weight	6.5kVA	

SF180-C3200 Range of Motion

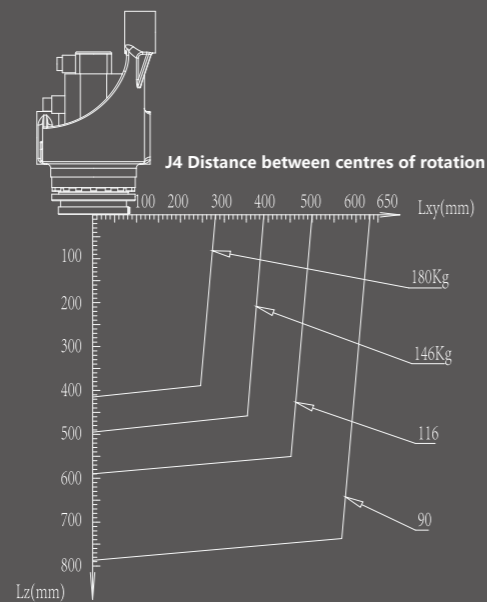
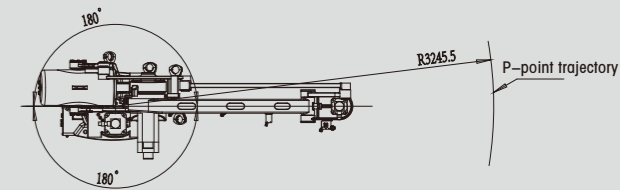
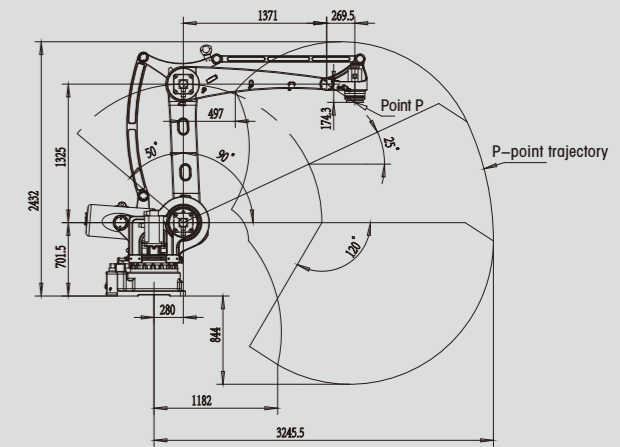

SF180-C3200 Wrist load torque chart

External & Installation Dimensions

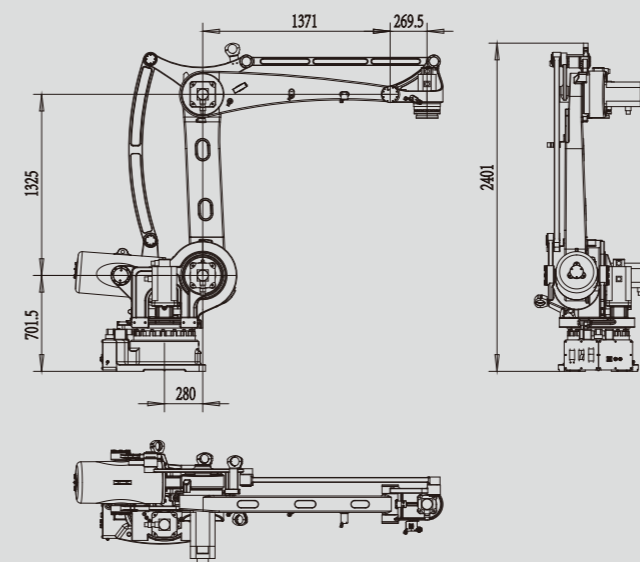

A-Way Diagram (End Flange Mounting Dimensions)

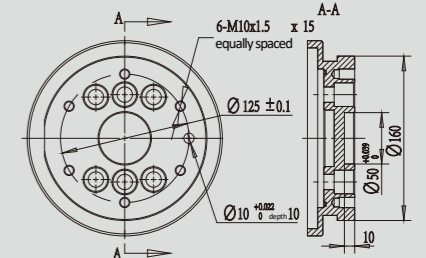

B-Way Diagram (Base Mounting Dimensions)

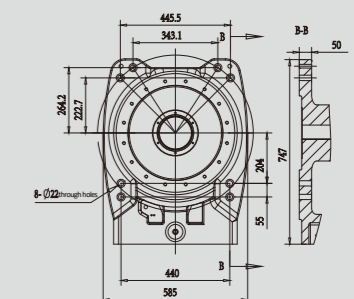



SF PA Series | Palletizing Robot
Model: SF210 - K3200

The SF PA series is fast, accurate, and powerful CHAIFU industrial robots for pallet stacking on the market. A complete product portfolio obtains higher economic benefits, high precision, low cost, and very efficient productivity.

The SF PA series for palletizing, handling, and stamping industrial applications offers unparalleled productivity and high performance in the market, completing a wide range of complete solutions quickly and precisely, with a low deadweight design to reduce cycle times.

With its low cost and high productivity, the SF PA is the perfect choice to benefit from the efficiency of your plant by achieving a total capacity increase with fast and accurate output in a small space.

Applications

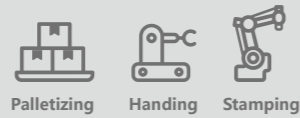

Palletizing Handling Stamping

SF210-K3200 Data Overview

Model	SF210-K3200	
Structure	Vertically Articulated	
Number of Axis	4	
Radius	3214mm	
Payload	210kg	
Repeatability	±0.3mm	
Drive Mode	AC Servo Motor	
Maximum Speed	J1	120° /s
	J2	140° /s
	J3	140° /s
	J4	305° /s
	J5	/
	J6	/
Range of Motion	J1	±180°
	J2	+45° /-80°
	J3	+15.5° /-115°
	J4	±360°
	J3-J2	-72° ≤ J3-J2 ≤ +67.5°
Allowable Moment	J4	1666N.M
	J5	/
	J6	/
Allowable Inertia	J4	80kg.m2
	J5	/
	J6	/
Protection Rating	IP 65, Wrist IP 67	
Operating Conditions	Temp.	0-45°C
	Humidity	Below 95%RH
	Vibration	Below 4.9m/s2
	Other	Eliminate Signal Noise
Base Size	710*700mm	
Height	2543mm	
Weight	1950KG	
Mounting Positions	Floor	
Weight	6.5kVA	

SF210-K3200 Range of Motion

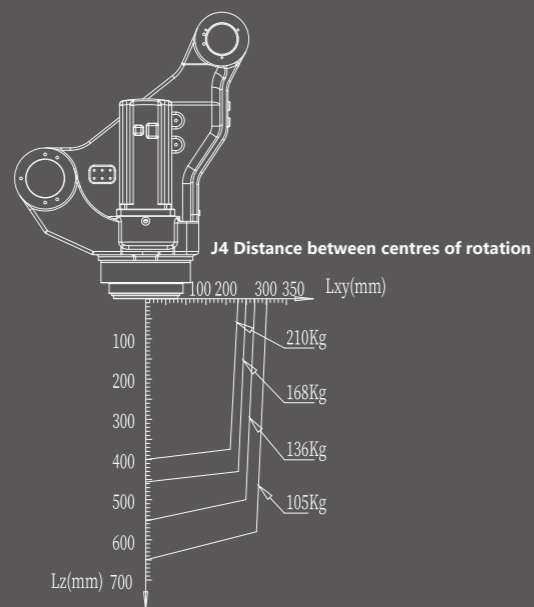
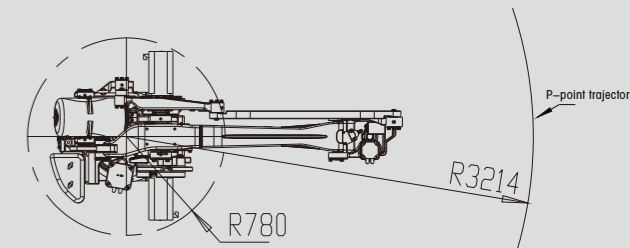
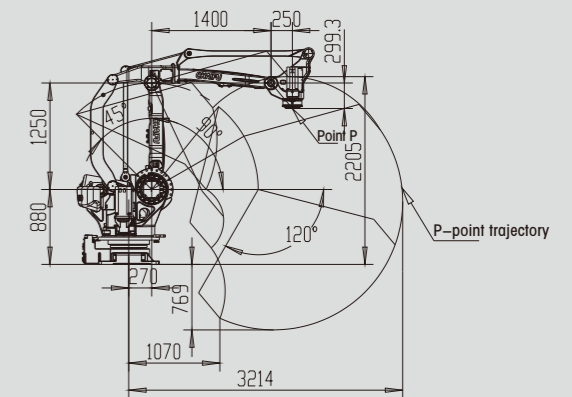

SF210-K3200 Wrist load torque chart

External & Installation Dimensions

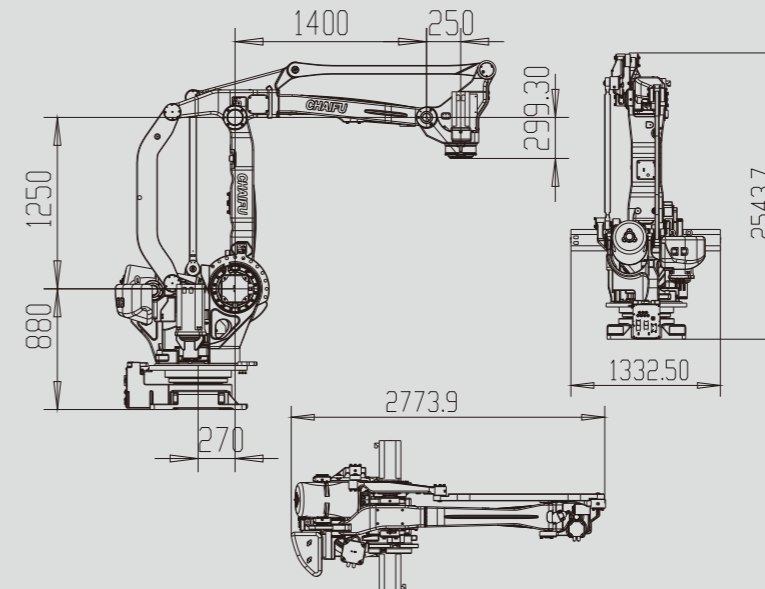

A-Way Diagram (End Flange Mounting Dimensions)

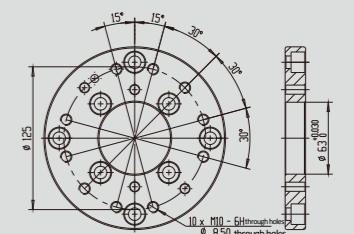

B-Way Diagram (Base Mounting Dimensions)

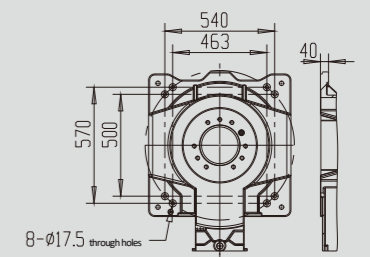

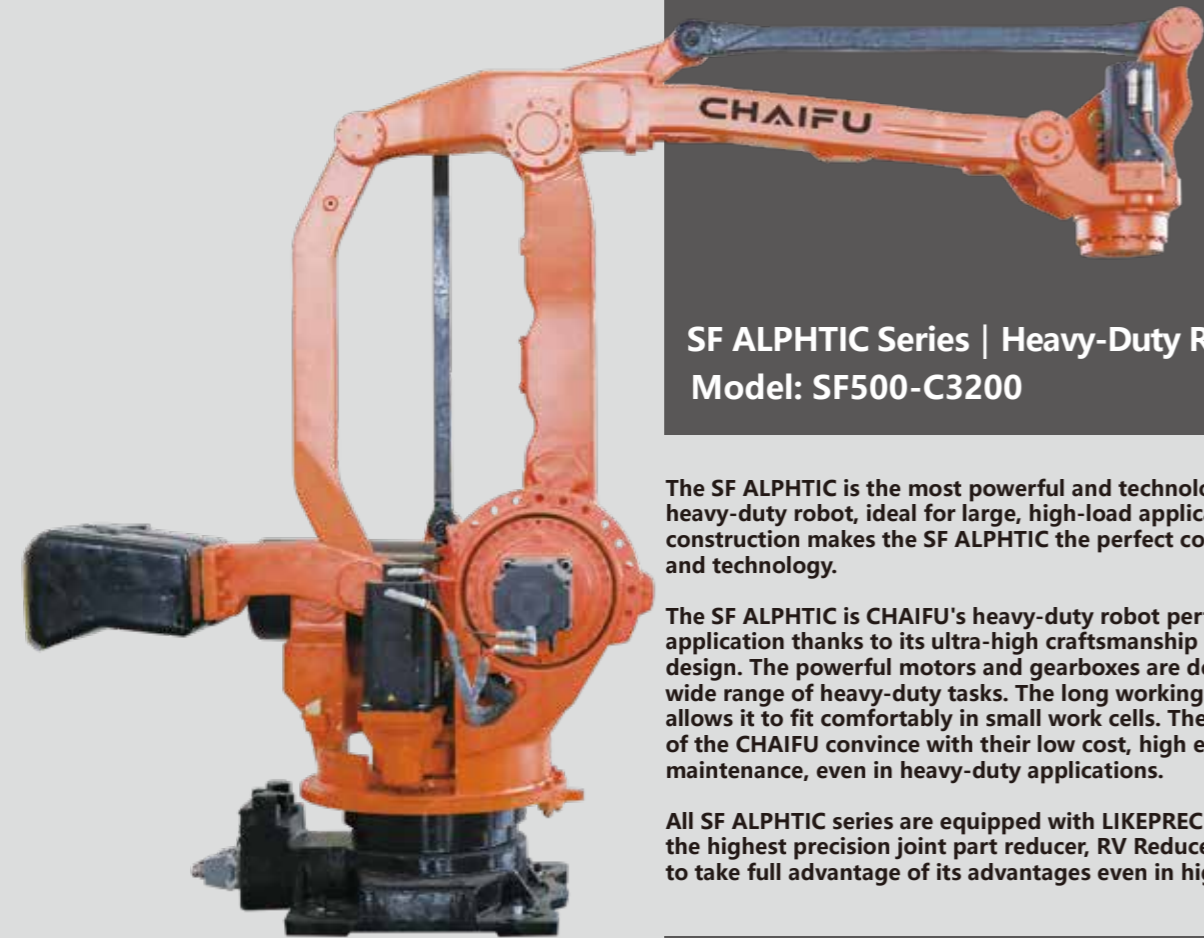

SF ALPHTIC Series | Heavy-Duty Robot
Model: SF500-C3200

The SF ALPHTIC is the most powerful and technologically advanced heavy-duty robot, ideal for large, high-load applications, and its rugged construction makes the SF ALPHTIC the perfect combination of power and technology.

The SF ALPHTIC is CHAIFU's heavy-duty robot perfectly matched to any application thanks to its ultra-high craftsmanship and rugged structural design. The powerful motors and gearboxes are designed to perform a wide range of heavy-duty tasks. The long working stroke of 3,177 mm allows it to fit comfortably in small work cells. The three core components of the CHAIFU convince with their low cost, high efficiency, and low maintenance, even in heavy-duty applications.

All SF ALPHTIC series are equipped with LIKEPRECISION technology and the highest precision joint part reducer, RV Reducer, which enables the robot to take full advantage of its advantages even in high-speed operation.

Applications



SF500-C3200 Data Overview

Model	SF500-C3200	
Structure	Vertically Articulated	
Number of Axis	4	
Radius	3177mm	
Payload	500kg	
Repeatability	±0.3mm	
Drive Mode	AC Servo Motor	
Maximum Speed	J1	100° /s
	J2	70° /s
	J3	70° /s
	J4	200° /s
	J5	/
	J6	/
Range of Motion	J1	±180°
	J2	+50° /-60°
	J3	+10° /-113°
	J4	±360°
	J3-J2	-68°≤J3-J2≤+75°
Allowable Moment	J4	2450N.M
	J5	/
	J6	/
Allowable Inertia	J4	90kg.m2
	J5	/
	J6	/
Protection Rating	IP 65, Wrist IP 67	
Operating Conditions	Temp.	0-45°C
	Humidity	Below 95%RH
	Vibration	Below 4.9m/s2
	Other	Eliminate Signal Noise
Base Size	710*700mm	
Height	2463mm	
Weight	2810KG	
Mounting Positions	Floor	
Weight	8kVA	

SF500-C3200 Range of Motion

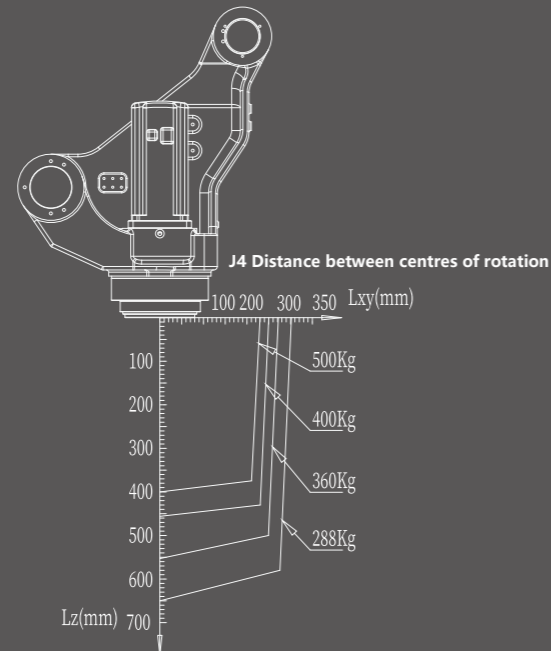
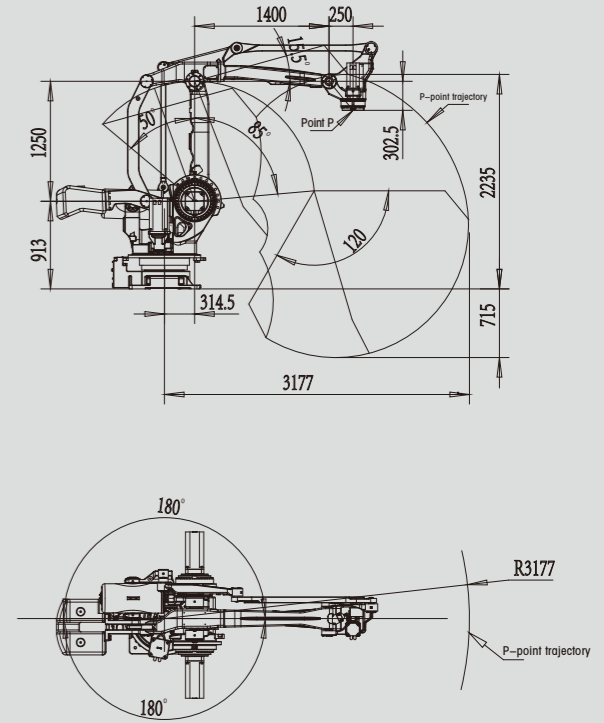

SF500-C3200 Wrist load torque chart

External & Installation Dimensions

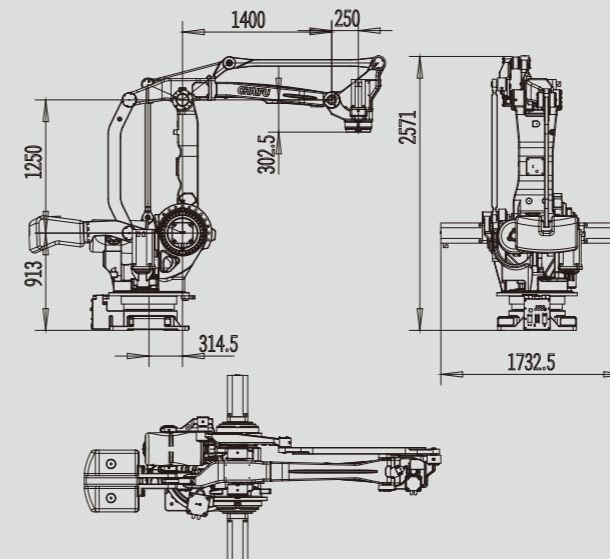

A-Way Diagram (End Flange Mounting Dimensions)

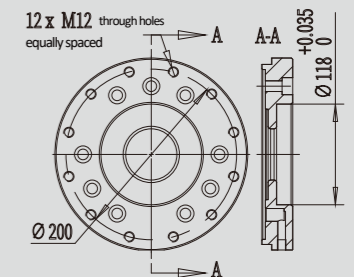

B-Way Diagram (Base Mounting Dimensions)

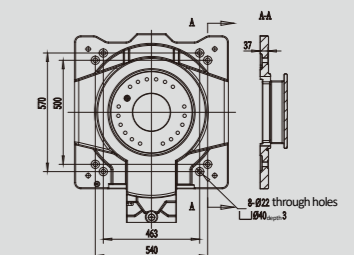



SF ALPHTIC Series | Heavy-Duty Robot
Model: SF800-C3200

The SF ALPHTIC is the most powerful and technologically advanced heavy-duty robot, ideal for large, high-load applications, and its rugged construction makes the SF ALPHTIC the perfect combination of power and technology.

The SF ALPHTIC is CHAIFU's heavy-duty robot perfectly matched to any application thanks to its ultra-high craftsmanship and rugged structural design. The powerful motors and gearboxes are designed to perform a wide range of heavy-duty tasks. The long working stroke of 3,177 mm allows it to fit comfortably in small work cells. The three core components of the CHAIFU convince with their low cost, high efficiency, and low maintenance, even in heavy-duty applications.

All SF ALPHTIC series are equipped with LIKEPRECISION technology and the highest precision joint part reducer, RV Reducer, which enables the robot to take full advantage of its advantages even in high-speed operation.

Applications

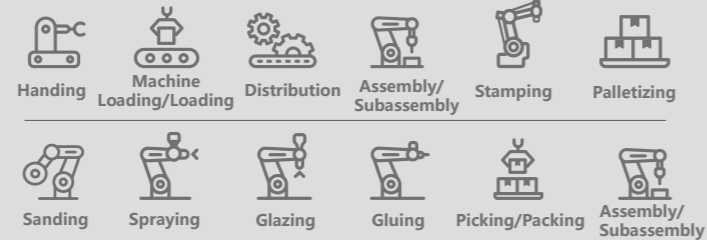

SF800-C3200 Data Overview

Model	SF800-C3200	
Structure	Vertically Articulated	
Number of Axis	4	
Radius	3177mm	
Payload	800kg	
Repeatability	±0.5mm	
Drive Mode	AC Servo Motor	
Maximum Speed	J1	60°/s
	J2	60°/s
	J3	60°/s
	J4	125°/s
	J5	/
	J6	/
Range of Motion	J1	±180°
	J2	+50° / -85°
	J3	+15.5° / -113°
	J4	±360°
	J3 - J2	-68° ≤ J3 - J2 ≤ +75°
Allowable Moment	J4	2450N.M
	J5	/
	J6	/
Allowable Inertia	J4	90kg.m ²
	J5	/
	J6	/
Protection Rating	IP 65, Wrist IP 67	
Operating Conditions	Temp.	0-45°C
	Humidity	Below 95%RH
	Vibration	Below 4.9m/s ²
	Other	Eliminate Signal Noise
Base Size	710*700mm	
Height	2629mm	
Weight	2968KG	
Mounting Positions	Floor	
Weight	8kVA	

SF800-C3200 Range of Motion

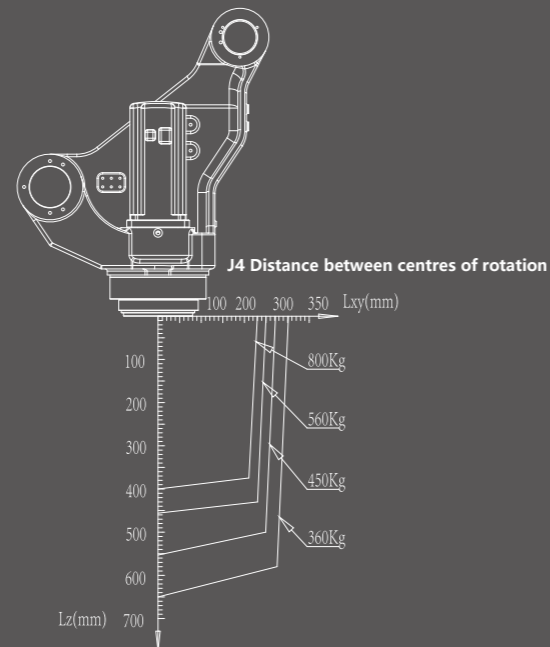
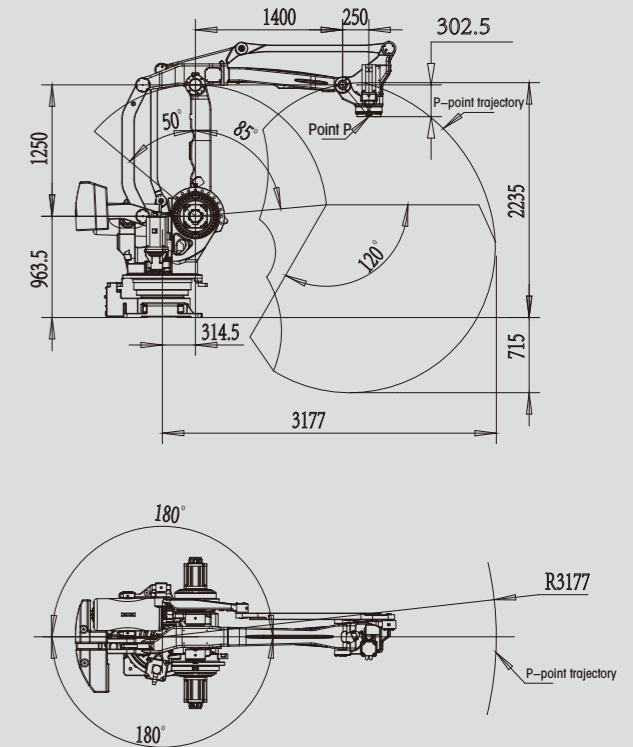

SF800-C3200 Wrist load torque chart

External & Installation Dimensions

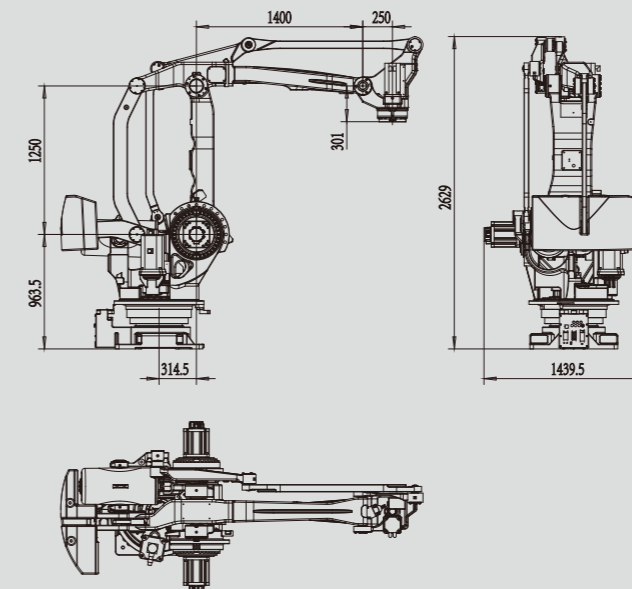

A-Way Diagram (End Flange Mounting Dimensions)

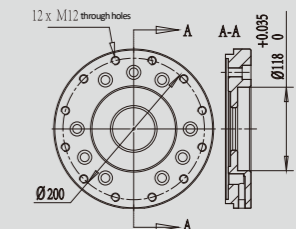

B-Way Diagram (Base Mounting Dimensions)

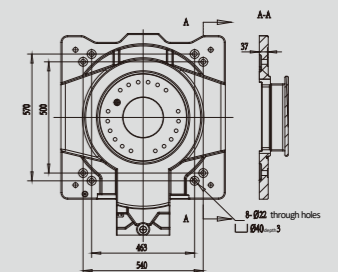

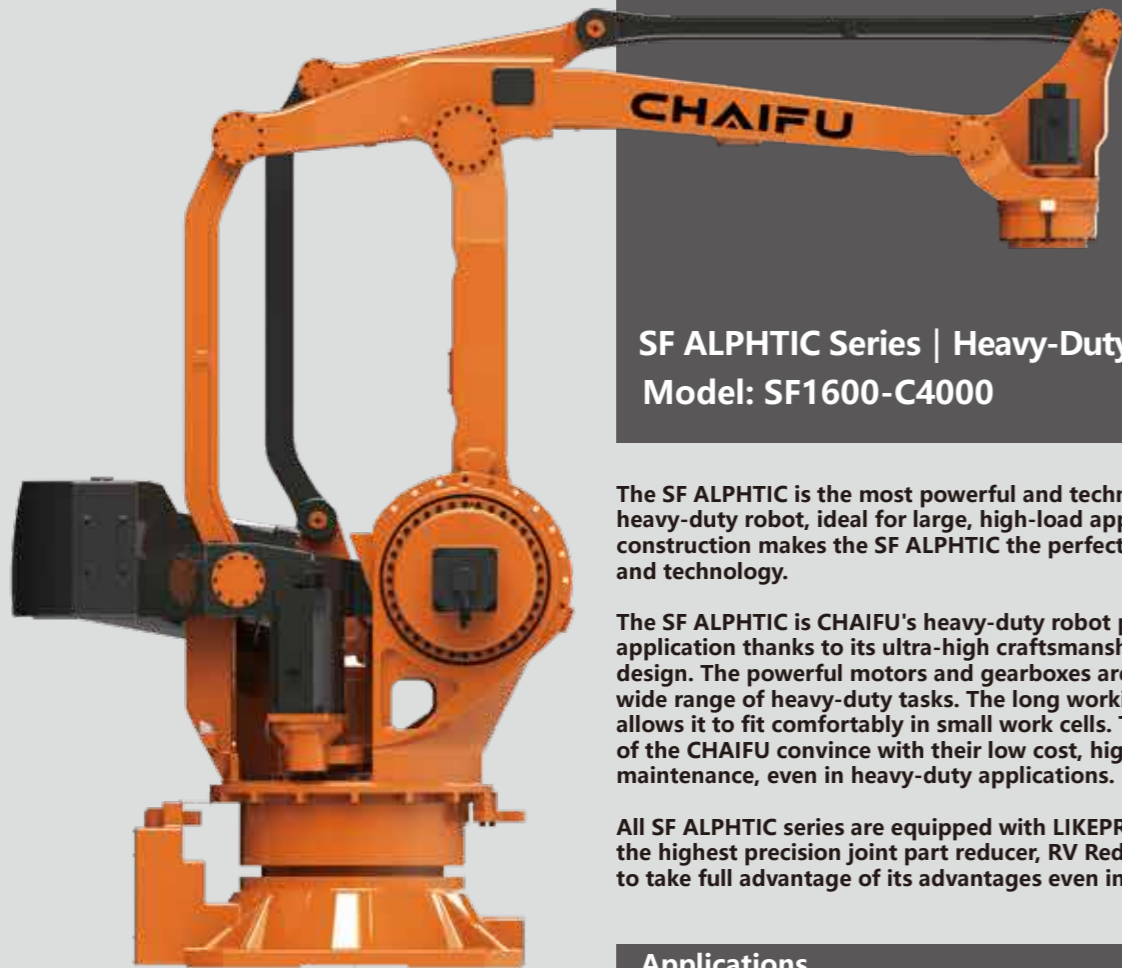

SF ALPHTIC Series | Heavy-Duty Robot
Model: SF1600-C4000

The SF ALPHTIC is the most powerful and technologically advanced heavy-duty robot, ideal for large, high-load applications, and its rugged construction makes the SF ALPHTIC the perfect combination of power and technology.

The SF ALPHTIC is CHAIFU's heavy-duty robot perfectly matched to any application thanks to its ultra-high craftsmanship and rugged structural design. The powerful motors and gearboxes are designed to perform a wide range of heavy-duty tasks. The long working stroke of 3,966 mm allows it to fit comfortably in small work cells. The three core components of the CHAIFU convince with their low cost, high efficiency, and low maintenance, even in heavy-duty applications.

All SF ALPHTIC series are equipped with LIKEPRECISION technology and the highest precision joint part reducer, RV Reducer, which enables the robot to take full advantage of its advantages even in high-speed operation.

Applications

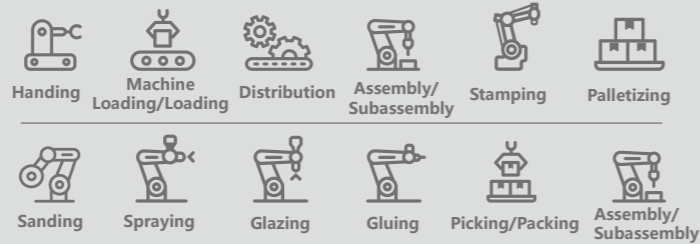

SF1600-C4000 Data Overview

Model	SF1600-C4000	
Structure	Vertically Articulated	
Number of Axis	4	
Radius	3966mm	
Payload	1600kg	
Repeatability	±0.8mm	
Drive Mode	AC Servo Motor	
Maximum Speed	J1	45°/s
	J2	30°/s
	J3	30°/s
	J4	70°/s
	J5	/
	J6	/
Range of Motion	J1	±180°
	J2	+50°/-90°
	J3	+20°/-115°
	J4	±360°
	J5	/
	J6	/
Allowable Moment	J4	8820N.M
	J5	/
	J6	/
Allowable Inertia	J4	2608Kg.m2
	J5	/
	J6	/
Protection Rating	IP 65, Wrist IP 67	
Operating Conditions	Temp.	0-45°C
	Humidity	Below 95%RH
	Vibration	Below 4.9m/s2
	Other	Eliminate Signal Noise
Base Size	1180*1180mm	
Height	3386mm	
Weight	6116KG	
Mounting Positions	Any angle	
Weight	14.5kVA	

SF1600-C4000 Range of Motion

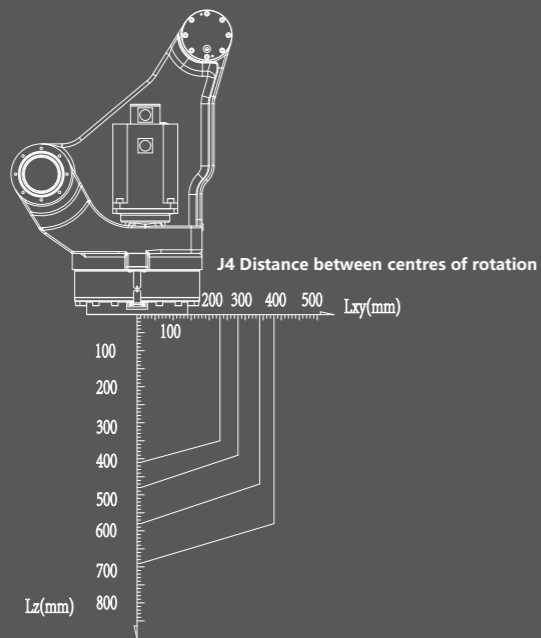
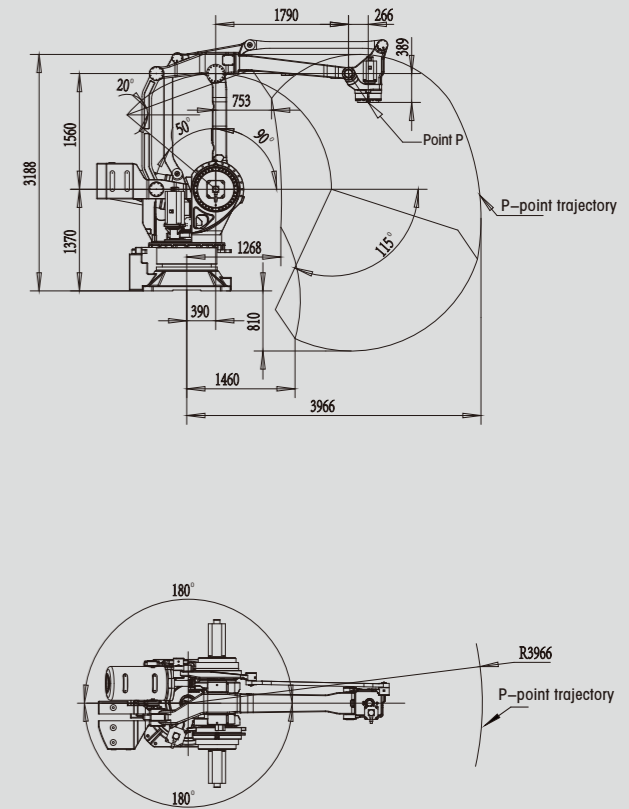

SF1600-C4000 Wrist load torque chart

External & Installation Dimensions

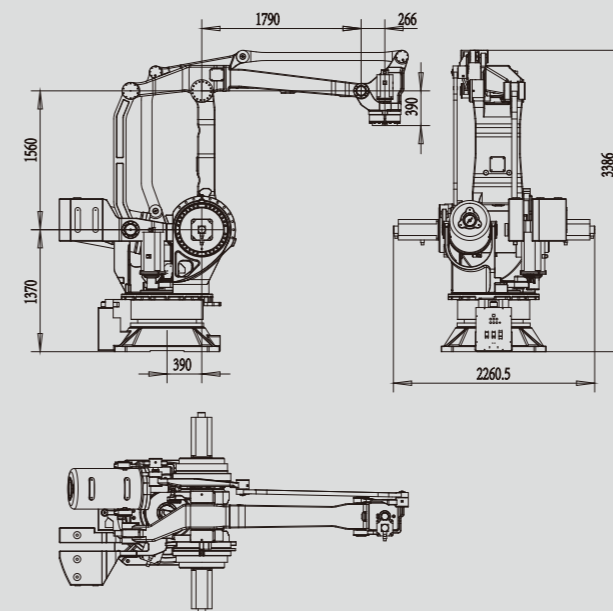

A-Way Diagram (End Flange Mounting Dimensions)

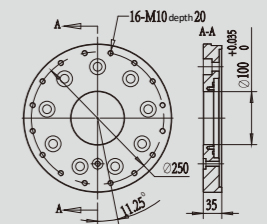

B-Way Diagram (Base Mounting Dimensions)

